

Variable Rotary Step Attenuators, 2 Watts

INDE®

Frequency: DC ~ 18 GHz

P/N: IVA-S2...18.. Series



Impedance : 50 Ω

Average Power : 2 W

Peak Power : 100W (5us pulse width
with 2% duty cycle)

Operating Temp : 20°C ~ 85°C

Ordering Code	Figure	Frequency Range (GHz)	Attenuation Range (dB) Step Size	MAX VSWR	Insertion Loss(dB)	Attenuation Accuracy (dB)	Connector Type
IVA-S2-1-10-6-A1	Fig 1	DC - 6	0-10 / 1	1.20-1.50	≤ 0.0	± 0.5	SMA(F,F)
IVA-S2-1-10-18-A5	Fig 3	DC-18	0-10/1	1.60	≤ 0.5	±1.0	SMA(F,F)
IVA-S2-1-60-2.5-A1	Fig 1	DC - 2.5	0-60 / 10	1.2	≤ 0.4	± 0.5	SMA(F,F)
IVA-S2-1-60-6-A1	Fig 1	DC - 6	0-60 / 10	1.20-1.50	≤ 0.0	±0.5(<50dB) ±0.8(≥50dB)	SMA(F,F)
IVA-S2-2-70-4.3-A2	Fig 2	DC - 4.3	0-70 / 1	1.25-1.50	≤ 0.5	±0.3dB(≤40dB) ±0.8dB(≤60dB) ±1.5dB(>60dB)	SMA(F,F)
IVA-S2-2-70-8-A6	Fig 5	DC-8	0-70/1	1.50	≤ 0.0	±0.5dB (0~9dB) ±1.0dB(10~19dB) ±1.5dB(20~49dB) ±1.9dB(50~70dB)	SMA(F,F)
IVA-S2-2-70-18-A6	Fig 5	DC-18	0-70/1	1.75	≤ 0.5	±0.5dB (0~9dB) ±1.0dB(10~19dB) ±1.5dB(20~49dB) ±1.9dB(50~70dB)	SMA(F,F)
IVA-S2-3-71-6-A4	Fig 6	DC-6	0-71/0.1	1.8	≤ 2.5	±0.3dB(0.1~1dB) ±0.4dB(1~10dB) ±0.8dB(10~60dB) ±1.5dB(≤71dB)	N (F,F)
IVA-S2-1-80-18-A5	Fig 4	DC-18	0-80/10	1.60	≤ 0.5	±2.5	SMA(F,F)
IVA-S2-1-90-3-A1	Fig 1	DC - 3	0-90 / 10	1.20-1.25	≤ 0.5	±0.5(≤60dB) ±3.5%(>60dB)	SMA(F,F)
IVA-S2-2-99-4-A6	Fig 5	DC-4	0-99/1	1.35	≤ 0.75	±0.5dB (0~9dB) ±1.0dB(10~19dB) ±1.5dB(20~49dB) ±1.9dB(50~69dB) ±2.5dB(70~99dB)	SMA(F,F)
IVA-S2-2-99-18-A6	Fig 5	DC-18	0-99/1	1.75	≤ 0.5	±0.5dB (0~9dB) ±1.0dB(10~19dB) ±1.5dB(20~49dB) ±1.9dB(50~69dB) ±2.5dB(70~99dB)	SMA(F,F)
IVA-S2-3-101-3-A4	Fig 6	DC-3	0-101/0.1	1.60	≤ 0.7	±0.2dB(0.1~1dB) ±0.4dB(1~10dB) ±0.8dB(10~60dB) ±1.5dB(<70dB) ±3.5%(≥70dB)	N (F,F)

N7

Cross reference is based on manufacturers datasheets and is indicative only. Customers have to verify themselves exact specifications. We accept no legal liability whatsoever for use of this cross reference by the customer. While the information, contained herein in this datasheet, has been carefully compiled to the best of our knowledge, nothing is intended as representation or warranty on our part and no statement herein shall be construed as recommendation to infringe existing patents. We accept no liability of whatsoever for any fault and errors in this datasheet. Contents of this datasheet and specifications of the products are subject to change without notice due to continuous improvement.

Variable Rotary Step Attenuators, 2 Watts

INDE®

Frequency: DC ~ 18 GHz

P/N: IVA-S2...18.. Series

VNA Plot for IVA-S2-1-10-6-A1 Variable Attenuator (0~10dB/6GHz)

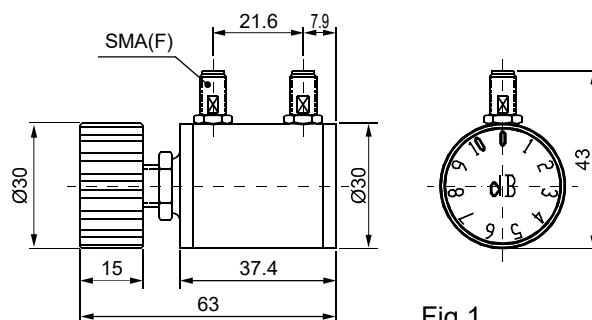
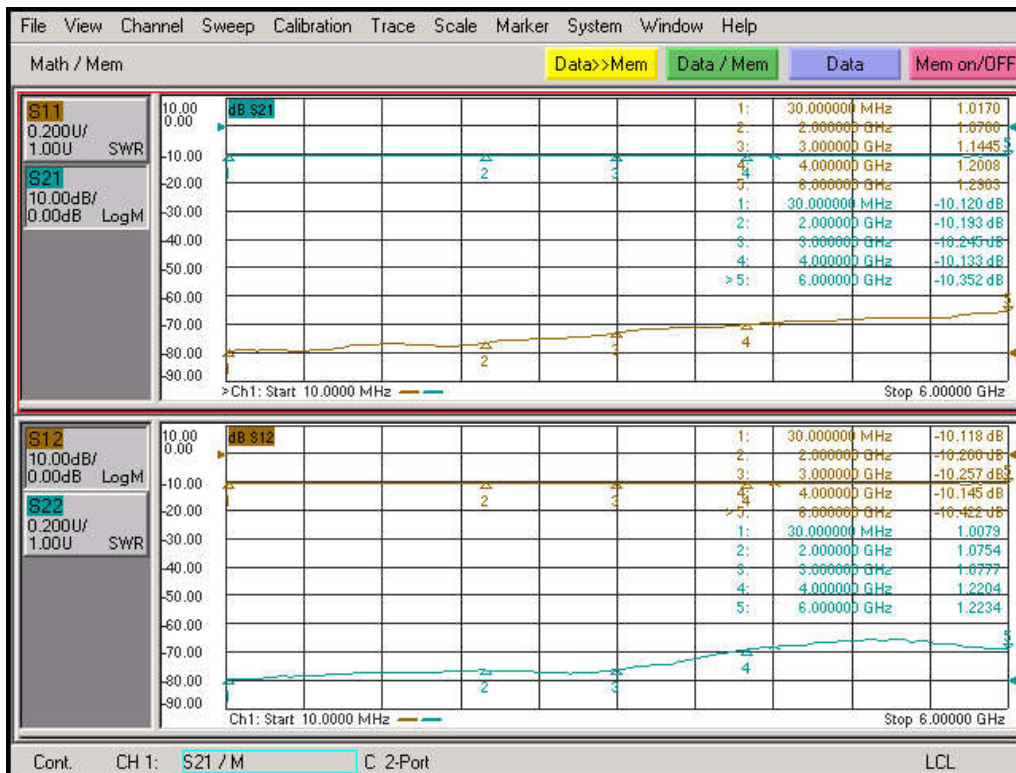

Fig 1

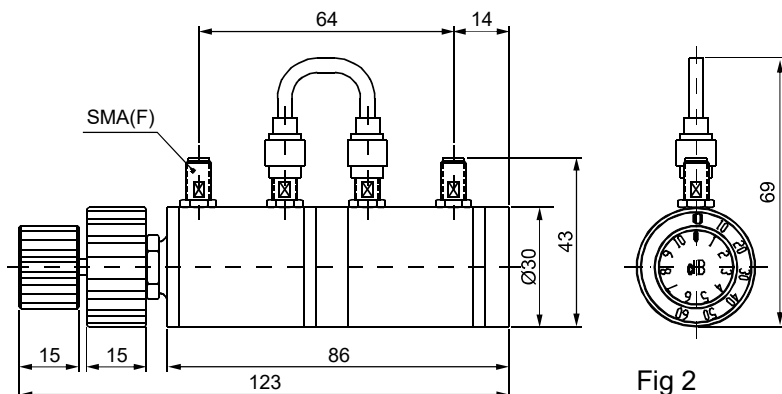

Fig 2

N7

Cross reference is based on manufacturers datasheets and is indicative only. Customers have to verify themselves exact specifications. We accept no legal liability whatsoever for use of this cross reference by the customer. While the information, contained herein in this datasheet, has been carefully compiled to the best of our knowledge, nothing is intended as representation or warranty on our part and no statement herein shall be construed as recommendation to infringe existing patents. We accept no liability of whatsoever for any fault and errors in this datasheet. Contents of this datasheet and specifications of the products are subject to change without notice due to continuous improvement.

Variable Rotary Step Attenuators, 2 Watts

INDE®

Frequency: DC ~ 18 GHz

P/N: IVA-S2...18.. Series

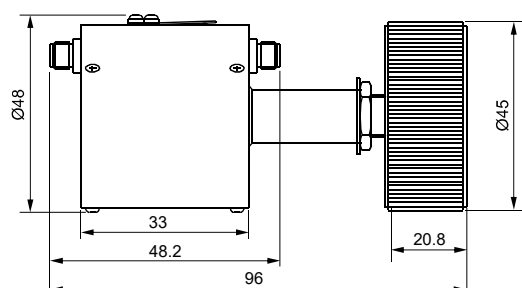

Fig 3

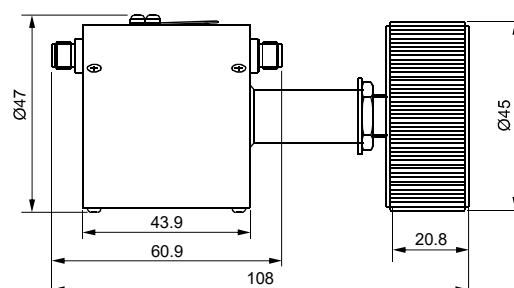

Fig 4

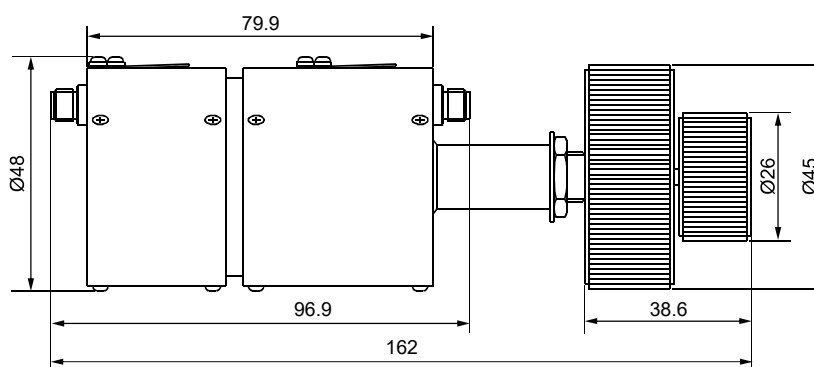

Fig 5

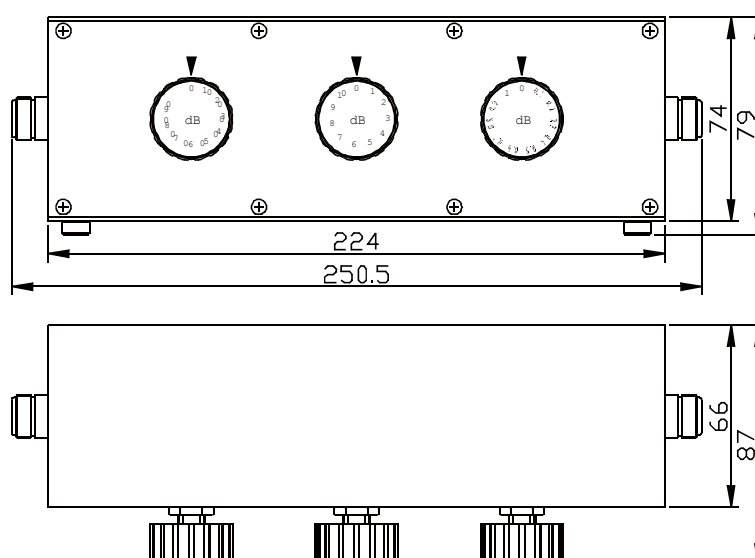

Fig 6

N7

Cross reference is based on manufacturers datasheets and is indicative only. Customers have to verify themselves exact specifications. We accept no legal liability whatsoever for use of this cross reference by the customer. While the information, contained herein in this datasheet, has been carefully compiled to the best of our knowledge, nothing is intended as representation or warranty on our part and no statement herein shall be construed as recommendation to infringe existing patents. We accept no liability of whatsoever for any fault and errors in this datasheet. Contents of this datasheet and specifications of the products are subject to change without notice due to continuous improvement.

Imported 2.92 Attenuators, 2W, 5W, 10W

INDE®

Frequency: DC ~ 40 GHz

P/N: IHPA-S1...2.92 Series



Impedance : 50 Ω

Operating Temp : -55°C ~125°C

Ordering Code	Freq. (GHz)	VSWR (max)	Figure	Avg. Power (W)	Attenuation and Accuracy (dB)						Connector
					1-5	6	10	20	30	40	
IHPA-S1-2-XX-40-2.92	DC-40	1.35	Fig 1	2 ¹⁾	±1.0	±1.0	±1.0	±1.0	-1.0/+1.5	-1.0/+2.0	2.92(M)-(F)
IHPA-S1-5-XX-40-2.92	DC-40	1.35	Fig 2	5 ²⁾	±1.0	±1.0	±1.0	±1.0	-1.0/+1.5	-1.0/+2.0	2.92(M)-(F)
IHPA-S1-10-XX-40-2.92	DC-40	1.40	Fig 3	10 ³⁾	/	/	-1.0/+2.0	-1.0/+1.5	-1.0/+1.5	-1.0/+2.0	2.92(M)-(F)

1) Average Power at 25°C ambient temperature, derated linearly to 0.5W @125°C. Peak Power is 0.2kW(5us pulse width with 0.5% duty cycle)

2) Average Power at 25°C ambient temperature, derated linearly to 0.5W @125°C. Peak Power is 0.2kW(5us pulse width with 1.25% duty cycle)

3) Average Power at 25°C ambient temperature, derated linearly to 1W @125°C. Peak Power is 0.2kW(5us pulse width with 1.25% duty cycle)

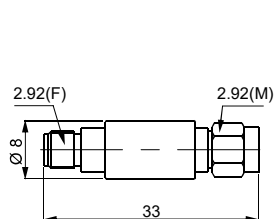

Fig 1

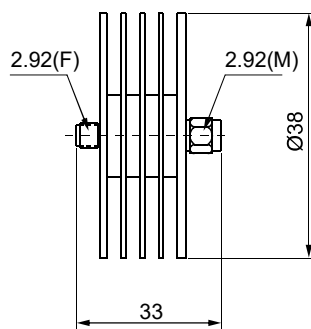

Fig 2

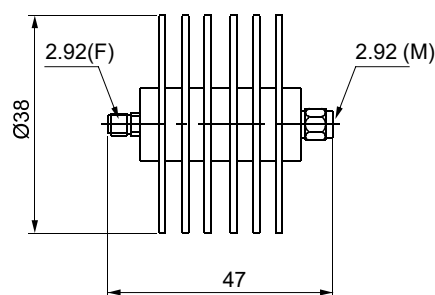

Fig 3

Cross reference is based on manufacturers datasheets and is indicative only. Customers have to verify themselves exact specifications. We accept no legal liability whatsoever for use of this cross reference by the customer. While the information, contained herein in this datasheet, has been carefully compiled to the best of our knowledge, nothing is intended as representation or warranty on our part and no statement herein shall be construed as recommendation to infringe existing patents. We accept no liability of whatsoever for any fault and errors in this datasheet. Contents of this datasheet and specifications of the products are subject to change without notice due to continuous improvement.

N8

Imported 2.92 Attenuators, 2W, 5W, 10W

Frequency: DC ~ 40 GHz

P/N: IHPA-S1...2.92 Series

INDE®

VNA Plot for IHPA-S1-2-10-40-2.92 Attenuator (10dB/2W/40GHz)

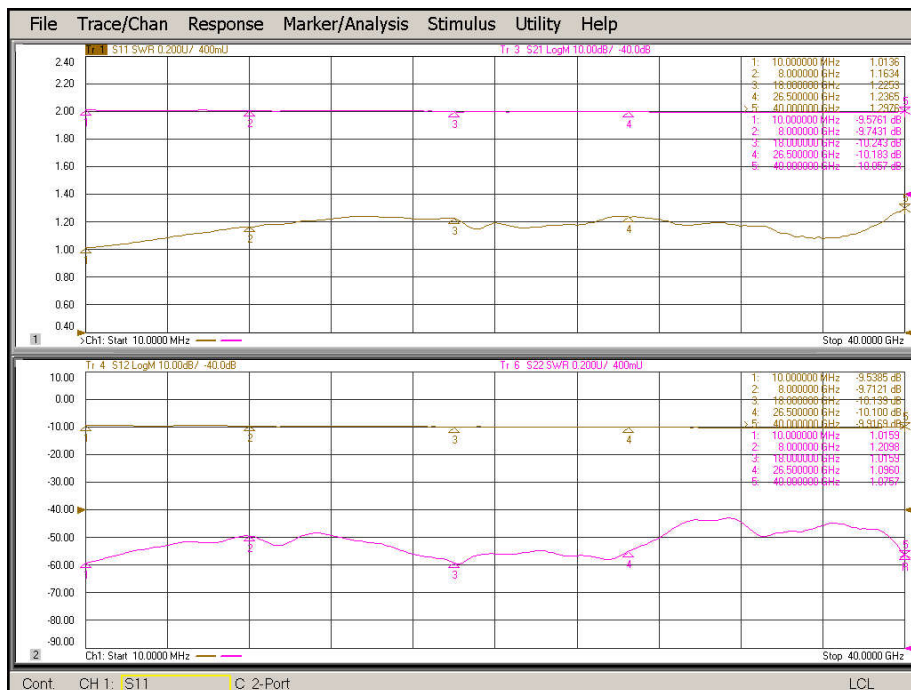

VNA Plot for IHPA-S1-5-06-40-2.92 Attenuator (6dB/5W/40GHz)

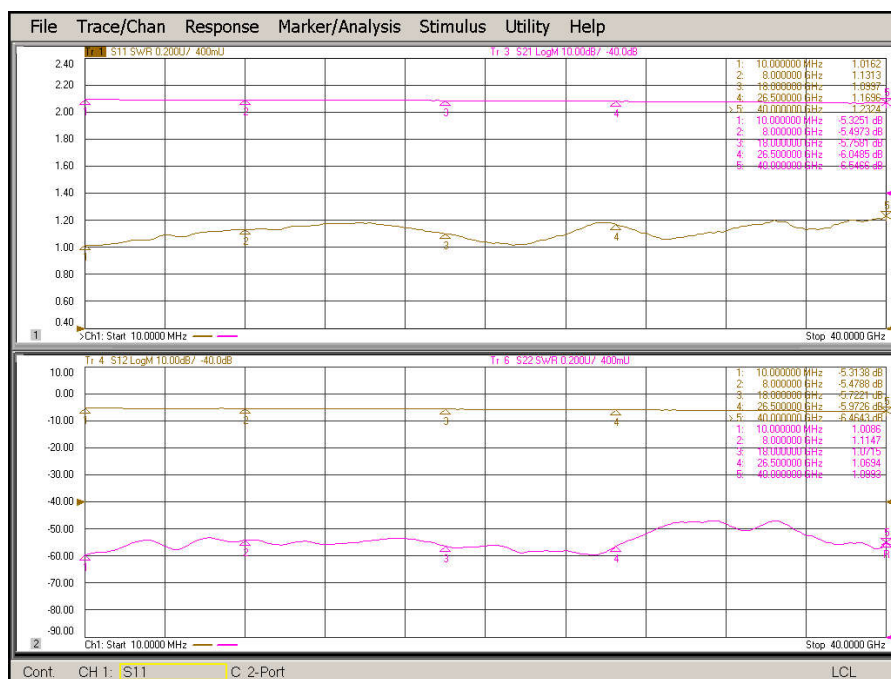

Cross reference is based on manufacturers datasheets and is indicative only. Customers have to verify themselves exact specifications. We accept no legal liability whatsoever for use of this cross reference by the customer. While the information, contained herein in this datasheet, has been carefully compiled to the best of our knowledge, nothing is intended as representation or warranty on our part and no statement herein shall be construed as recommendation to infringe existing patents. We accept no liability of whatsoever for any fault and errors in this datasheet. Contents of this datasheet and specifications of the products are subject to change without notice due to continuous improvement.

N8

Imported 3.5mm Attenuators, 2W, 5W, 10W

INDE®

Frequency: DC ~ 26.5 GHz

P/N: IHPA-S1...3.5 Series



Impedance : 50 Ω

Operating Temp : -55°C ~85°C

Ordering Code	Freq. (GHz)	VSWR (max)	Figure	Avg. Power (W)	Attenuation and Accuracy (dB)				Connector
					1-9	10	20	30	
IHPA-S1-2-XX-26.5-3.5	DC-26.5	1.25	Fig 1	2 ¹⁾	-0.3/+1.0	-0.3/+1.0	-0.3/+1.0	-0.3/+1.0	3.5(M)-(F)
IHPA-S1-5-XX-26.5-3.5	DC-26.5	1.25	Fig 2	5 ²⁾	±1.0	-0.5/+1.2	-0.5/+1.2	-0.5/+1.2	3.5(M)-(F)
HPA-S1-10-XX-26.5-3.5	DC-26.5	1.25	Fig 3	10 ³⁾	±1.0	±1.0	-0.5/+1.2	-0.5/+1.2	3.5(M)-(F)

1) Average Power at 25°C ambient temperature, derated linearly to 0.5W @125°C. Peak Power is 0.5kW(5us pulse width with 0.2% duty cycle)

2) Average Power at 25°C ambient temperature, derated linearly to 0.5W @125°C. Peak Power is 0.5kW(5us pulse width with 0.5% duty cycle)

3) Average Power at 25°C ambient temperature, derated linearly to 1W @125°C. Peak Power is 1kW(5us pulse width with 0.5% duty cycle)

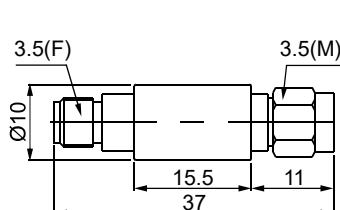

Fig 1

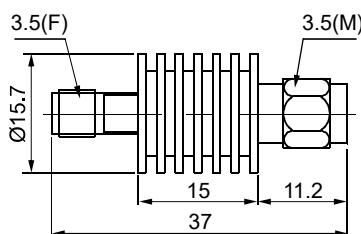

Fig 2

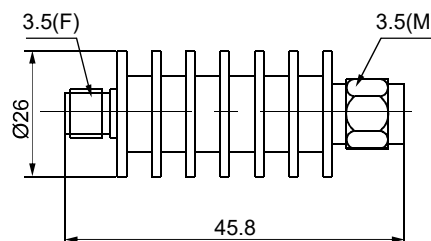

Fig 3

Cross reference is based on manufacturers datasheets and is indicative only. Customers have to verify themselves exact specifications. We accept no legal liability whatsoever for use of this cross reference by the customer. While the information, contained herein in this datasheet, has been carefully compiled to the best of our knowledge, nothing is intended as representation or warranty on our part and no statement herein shall be construed as recommendation to infringe existing patents. We accept no liability of whatsoever for any fault and errors in this datasheet. Contents of this datasheet and specifications of the products are subject to change without notice due to continuous improvement.

N8

Imported 3.5mm Attenuators, 2W, 5W, 10W

Frequency: DC ~ 26.5 GHz

P/N: IHPA-S1...3.5 Series

INDE[®]

VNA Plot for IHPA-S1-2-20-26.5-3.5 Attenuator (20dB/2W/26.5GHz)

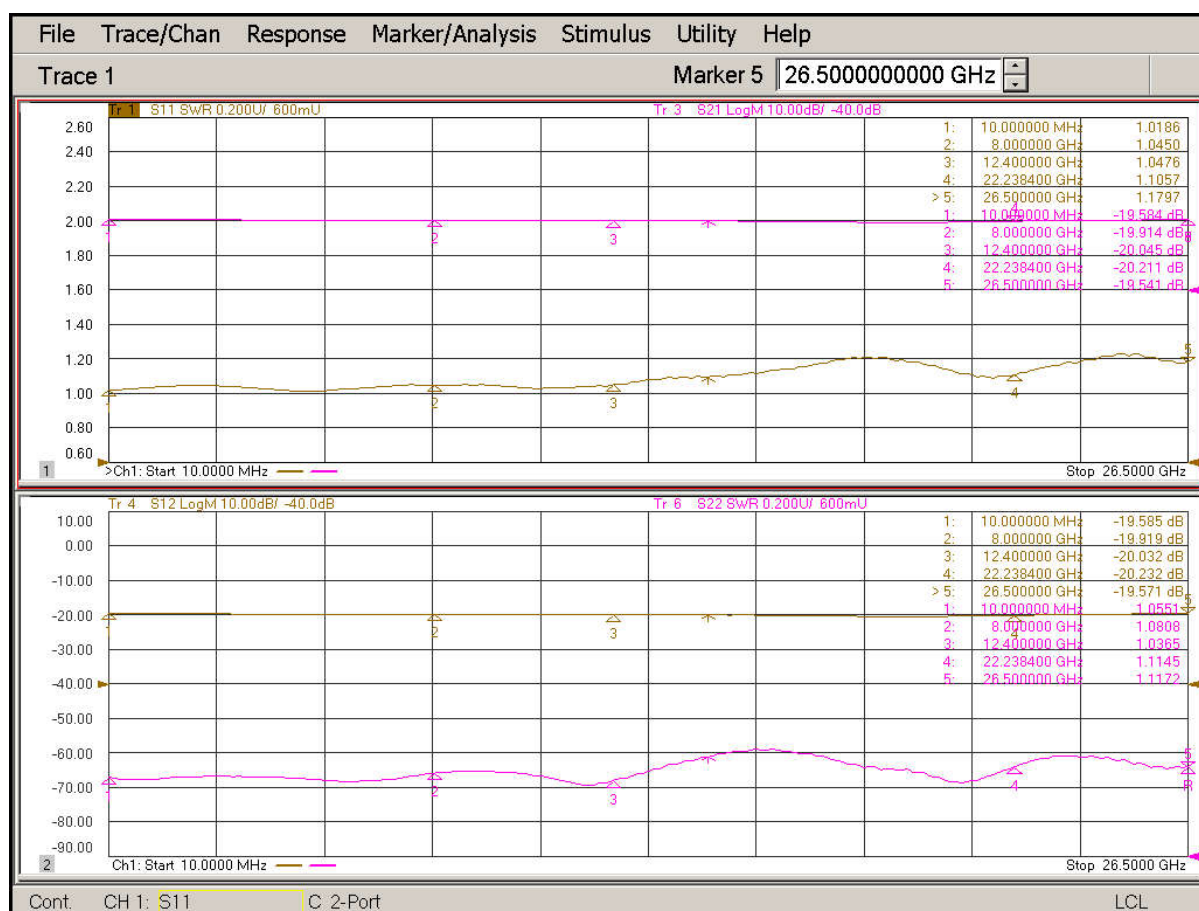

Cross reference is based on manufacturers datasheets and is indicative only. Customers have to verify themselves exact specifications. We accept no legal liability whatsoever for use of this cross reference by the customer. While the information, contained herein in this datasheet, has been carefully compiled to the best of our knowledge, nothing is intended as representation or warranty on our part and no statement herein shall be construed as recommendation to infringe existing patents. We accept no liability of whatsoever for any fault and errors in this datasheet. Contents of this datasheet and specifications of the products are subject to change without notice due to continuous improvement.

N8

Imported SMA Attenuators, 2W		INDE®
Frequency: DC ~ 26.5 GHz	P/N: IHP-??-2.. Series	



Impedance : 50 Ω

Operating Temp : -55°C ~85°C

Ordering Code	Freq. (GHz)	VSWR (max)	Figure	Avg. Power (W)	Attenuation and Accuracy (dB)						Connector
					1-5	6	10	20	30	40	
IHPA-S2-2-XX-4	DC-4	1.15	Fig 1	2 ¹⁾	±0.5	±0.5	±0.5	±0.6	±0.6	/	SMA(M)-(F)
IHPA-S2-2-XX-12.4	DC-12.4	1.30	Fig 1	2 ¹⁾	±0.8	±0.8	±0.75	±1.0	±1.0	/	SMA(M)-(F)
IHPA-S2-2-XX-18	DC-18	1.35	Fig 1	2	±1.0	±1.0	±1.0	±1.0	±1.0	/	SMA(M)-(F)
IHPA-S1-2-XX-18-D	DC-18	1.30	Fig 2	2 ¹⁾	±0.8	±0.8	±0.8	±0.8	±0.8	±0.8	SMA(M)-(F)
IHPA-S1-2-XX-26.5-D	DC-26.5	1.35	Fig 2	2 ¹⁾	±1.0	±1.0	±1.0	±1.0	±1.0	±1.0	SMA(M)-(F)

1) Average Power at 25°C ambient temperature, derated linearly to 0.5W @125°C. Peak Power is 0.5kW(5us pulse width with 0.4% duty cycle)

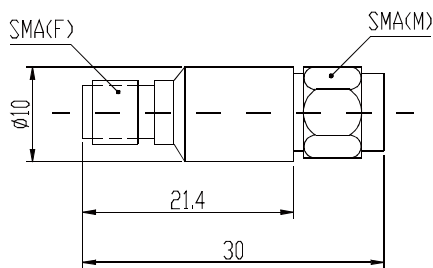

Fig 1

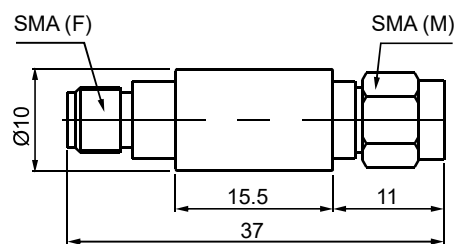

Fig 2

Imported SMA Attenuators, 2W

Frequency: DC ~ 26.5 GHz

P/N: IHP-??-2.. Series



VNA Plot for IHPA-S2-2-XX-18 Attenuator (6dB/2W/18GHz)

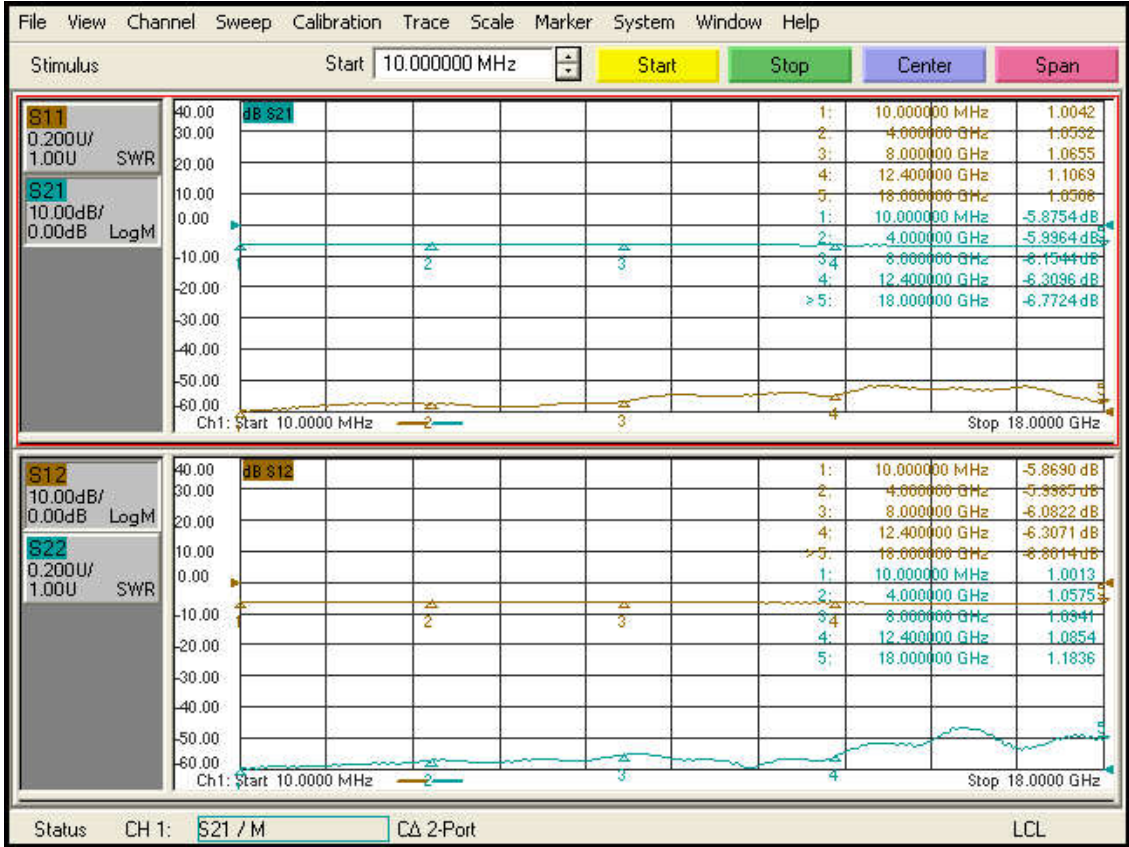

Imported SMA Attenuators, 5W

INDE®

Frequency: DC ~ 26.5 GHz

P/N: IHPA-??-5.. Series



Impedance : 50 Ω

Operating Temp : -55°C ~125°C

Ordering Code	Freq. (GHz)	VSWR (max)	Figure	Avg. Power (W)	Attenuation and Accuracy (dB)						Connector
					3	6	10	20	30	40	
IHPA-T4-5-XX-4-S	DC-4	<1.10@1 GHz <1.15@2 GHz <1.20 @4 GHz	Fig 2	5 ¹⁾	±0.4	±0.4	±0.5	±0.5	±0.6	±0.6	SMA(M)-(F)
IHPA-S1-5-XX-12.4-A	DC-12.4	1.25	Fig 1	5 ¹⁾	±0.5	±0.5	±0.5	±0.5	±0.5	±0.5	SMA(M)-(F)
IHPA-S1-5-XX-18-A	DC-18	1.30	Fig 1	5 ¹⁾	-0.5/ +0.8	-0.5/ +0.8	±1.0	±1.0	±1.0	±1.0	SMA(M)-(F)
IHPA-S1-5-XX-26.5-A	DC-26.5	1.35	Fig 1	5 ¹⁾	±1.0	±1.0	±1.0	-0.5/ +1.5	-0.5/ +1.5	-0.5/ +1.5	SMA(M)-(F)

1) Average Power at 25°C ambient temperature, derated linearly to 0.5W @125°C. Peak Power is 1kW(5us pulse width with 0.5% duty cycle)

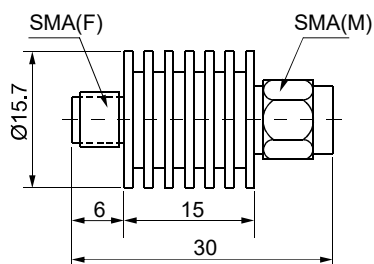

Fig 1

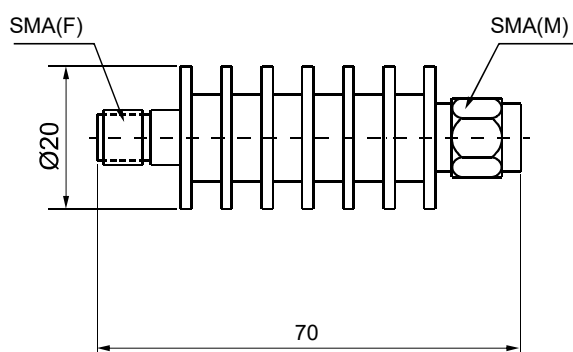

Fig 2

Cross reference is based on manufacturers datasheets and is indicative only. Customers have to verify themselves exact specifications. We accept no legal liability whatsoever for use of this cross reference by the customer. While the information, contained herein in this datasheet, has been carefully compiled to the best of our knowledge, nothing is intended as representation or warranty on our part and no statement herein shall be construed as recommendation to infringe existing patents. We accept no liability of whatsoever for any fault and errors in this datasheet. Contents of this datasheet and specifications of the products are subject to change without notice due to continuous improvement.

N10

Imported SMA Attenuators, 5W

Frequency: DC ~ 26.5 GHz

P/N: IHPA-??-5.. Series

INDE[®]

VNA Plot for IHPA-S1-5-06-18-A Attenuator (6dB/5W/18GHz)

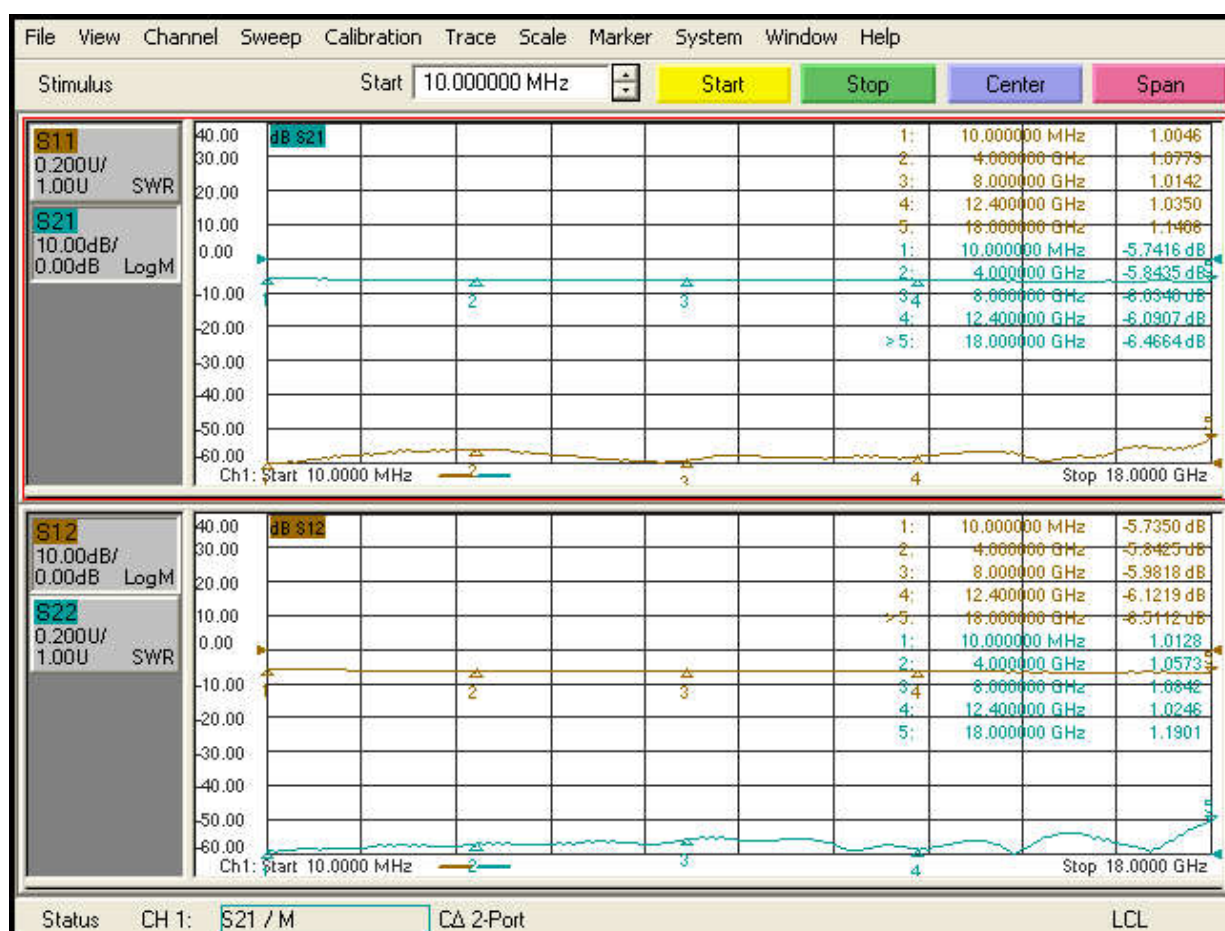

Cross reference is based on manufacturers datasheets and is indicative only. Customers have to verify themselves exact specifications. We accept no legal liability whatsoever for use of this cross reference by the customer. While the information, contained herein in this datasheet, has been carefully compiled to the best of our knowledge, nothing is intended as representation or warranty on our part and no statement herein shall be construed as recommendation to infringe existing patents. We accept no liability of whatsoever for any fault and errors in this datasheet. Contents of this datasheet and specifications of the products are subject to change without notice due to continuous improvement.

N10

Imported SMA Attenuators, 10W

INDE®

Frequency: DC ~ 26.5 GHz

P/N: IHPA-??-10.. Series



Impedance : 50 Ω

Operating Temp : -55°C ~125°C

Inde P/N	Freq. (GHz)	VSWR (max)	Figure	Avg. Power (W)	Attenuation and Accuracy (dB)						Connector
					3	6	10	20	30	40	
IHPA-D2-10-XX-4-S	DC-4	<1.15@3 GHz <1.20 @4 GHz	Fig 2	10 ⁻²	±0.5	±0.5	±0.6	±0.6	±0.6	±0.8	SMA(M)-(F)
IHPA-S1-10-XX-8-A	DC-8	1.20	Fig 1	10 ⁻¹	±0.4	±0.4	±0.5	±0.5	±0.5	±0.5	SMA(M)-(F)
IHPA-S1-10-XX-12.4-A	DC-12.4	1.25	Fig 1	10 ⁻¹	±0.6	±0.6	±0.6	±0.6	±0.6	±0.6	SMA(M)-(F)
IHPA-S1-10-XX-18-A	DC-18	1.30	Fig 1	10 ⁻¹	±0.8	±0.8	±1.0	±1.0	±1.0	±1.0	SMA(M)-(F)
IHPA-S1-10-XX-26.5-A	DC-26.5	1.35	Fig 1	10 ⁻¹	-0.5/ +1.0	-0.5/ +1.0	-0.5/ +1.5	-0.5/ +1.2	±1.2	±1.2	SMA(M)-(F)

- 1) Average Power at 25°C ambient temperature, derated linearly to 1W @125°C. Peak Power is 1kW(5us pulse width with 0.5% duty cycle)
- 2) Average Power at 25°C ambient temperature, derated linearly to 1W @125°C. Peak Power is 1kW(5us pulse width with 1% duty cycle)

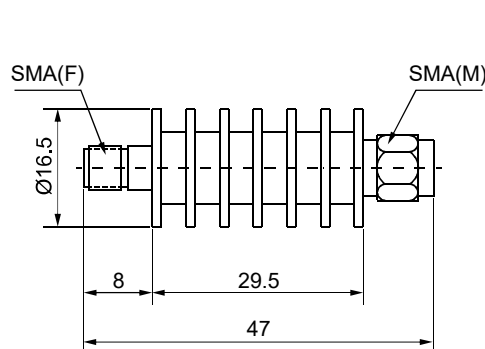

Fig 1

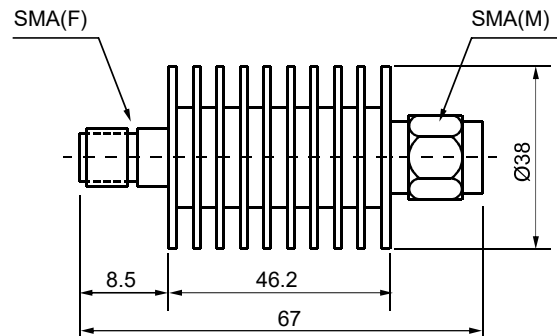

Fig 2

Imported SMA Attenuators, 10W

Frequency: DC ~ 26.5 GHz

P/N: IHPA-??-10.. Series

INDE[®]

VNA Plot for IHPA-S1-10-06-26.5 Attenuator (6dB/10W/26.5GHz)

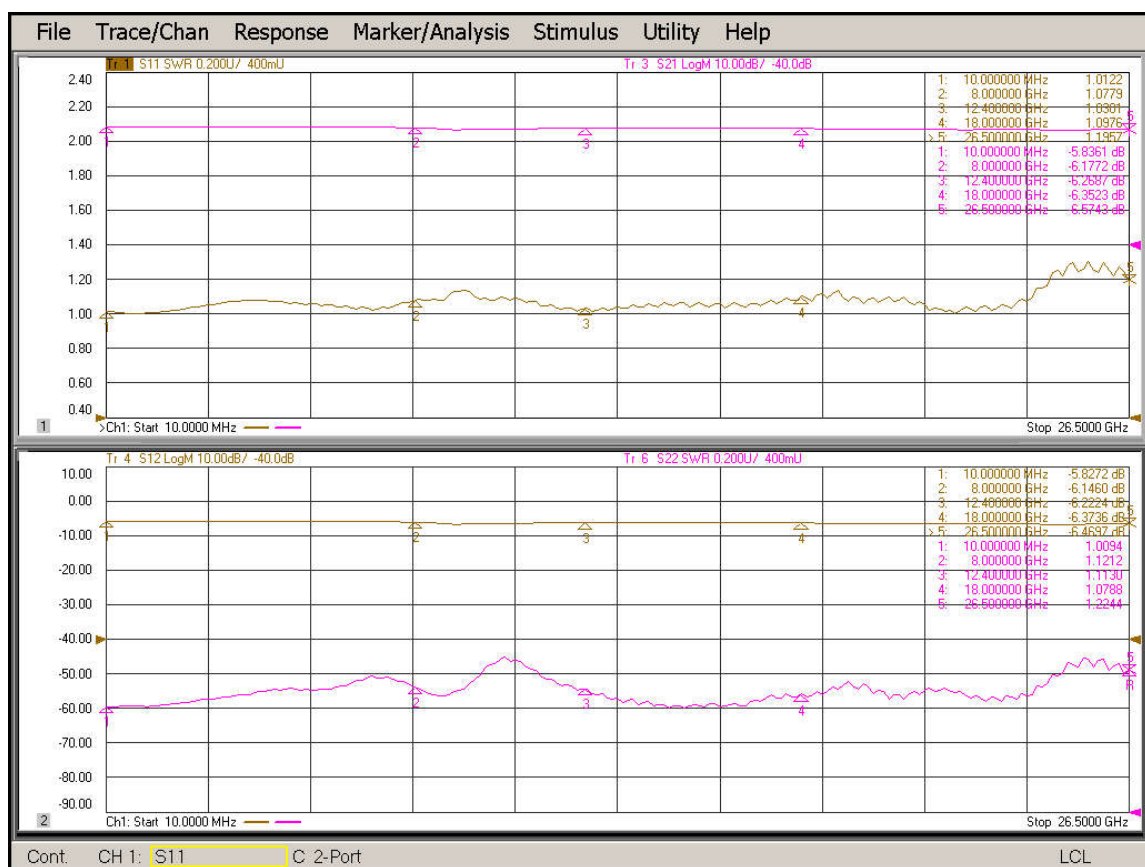

N11

Cross reference is based on manufacturers datasheets and is indicative only. Customers have to verify themselves exact specifications. We accept no legal liability whatsoever for use of this cross reference by the customer. While the information, contained herein in this datasheet, has been carefully compiled to the best of our knowledge, nothing is intended as representation or warranty on our part and no statement herein shall be construed as recommendation to infringe existing patents. We accept no liability of whatsoever for any fault and errors in this datasheet. Contents of this datasheet and specifications of the products are subject to change without notice due to continuous improvement.

Imported SMA High Power Attenuators, 25W

INDE®

Frequency: DC ~ 26.5 GHz

P/N: IHPA-??-25.. Series



Impedance : 50 Ω

Operating Temp : -55°C ~125°C

Ordering Code	Freq. (GHz)	VSWR (max)	Figure	Avg. Power (W)	Attenuation and Accuracy (dB)						Connector
					3	6	10	20	30	40	
IHPA-D2-25-XX-4-S-A	DC-4	<1.05@1 GHz <1.10 @2 GHz <1.15@3 GHz <1.25 @4 GHz	Fig 1	25 ¹⁾	±0.5	±0.5	±0.6	±0.6	±0.6	±1.0	SMA(M)-(F)
IHPA-D1-25-XX-8-C	DC-8	1.20	Fig 2	25 ¹⁾	/	/	±0.4	±0.5	±0.5	±0.5	SMA(M)-(F)
IHPA-D1-25-XX-12.4-C	DC-12.4	1.25	Fig 2	25 ¹⁾	/	/	±0.5	±0.8	±0.8	±0.8	SMA(M)-(F)
IHPA-D1-25-XX-18-C	DC-18	1.30	Fig 2	25 ¹⁾	/	/	±1.0	±1.0	±1.0	±1.0	SMA(M)-(F)
IHPA-D1-25-XX-26.5-C	DC-26.5	1.35	Fig 2	25 ¹⁾	/	/	±1.2	±1.2	±1.2	±1.2	SMA(M)-(F)

1) Average Power at 25°C ambient temperature, derated linearly to 2.5W @125°C. Peak Power is 1kW(5us pulse width with 2.5% duty cycle)

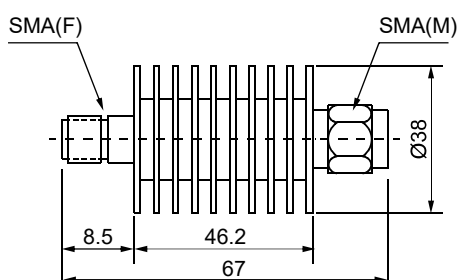

Fig 1

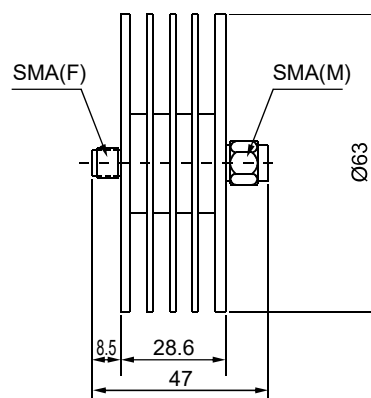

Fig 2

Cross reference is based on manufacturers datasheets and is indicative only. Customers have to verify themselves exact specifications. We accept no legal liability whatsoever for use of this cross reference by the customer. While the information, contained herein in this datasheet, has been carefully compiled to the best of our knowledge, nothing is intended as representation or warranty on our part and no statement herein shall be construed as recommendation to infringe existing patents. We accept no liability of whatsoever for any fault and errors in this datasheet. Contents of this datasheet and specifications of the products are subject to change without notice due to continuous improvement.

N12

Imported SMA High Power Attenuators, 25W

Frequency: DC ~ 26.5 GHz

P/N: IHPA-??-25.. Series

INDE[®]

VNA Plot for IHPA-D2-25-10-4-S-A Attenuator (10dB/25W/4GHz)

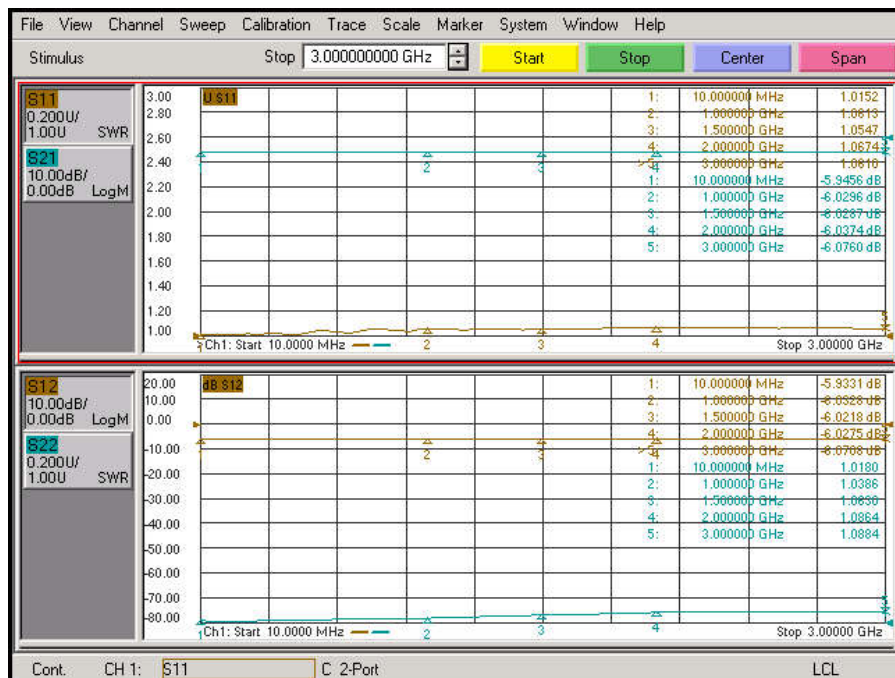

VNA Plot for IHPA-D1-25-10-18-C Attenuator (10dB/25W/18GHz)

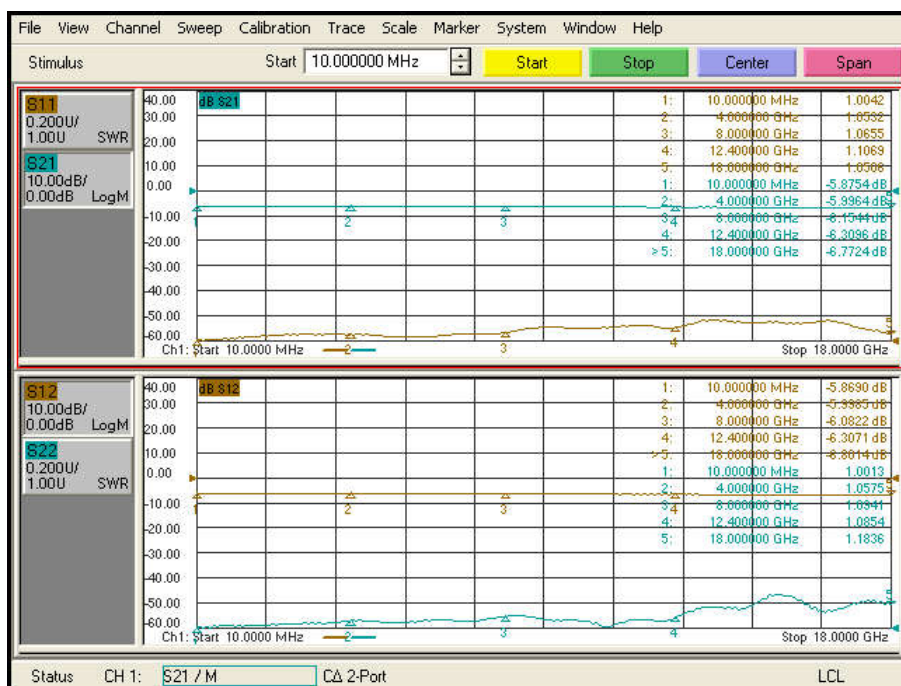

Cross reference is based on manufacturers datasheets and is indicative only. Customers have to verify themselves exact specifications. We accept no legal liability whatsoever for use of this cross reference by the customer. While the information, contained herein in this datasheet, has been carefully compiled to the best of our knowledge, nothing is intended as representation or warranty on our part and no statement herein shall be construed as recommendation to infringe existing patents. We accept no liability of whatsoever for any fault and errors in this datasheet. Contents of this datasheet and specifications of the products are subject to change without notice due to continuous improvement.

N12

Imported SMA High Power Attenuators, 50W

INDE®

Frequency: DC ~ 26.5 GHz

P/N: IHPA-??-50.. Series



Impedance : 50 Ω

Operating Temp : -55°C ~125°C

Ordering Code	Freq. (GHz)	VSWR (max)	Figure	Avg. Power (W)	Attenuation and Accuracy (dB)					Connector
					3/6	10	20	30	40	
IHPA-D3-50-XX-4-S-A	DC-4	1.35	Fig 2	50 ¹⁾	±0.75	±0.75	±0.75	±0.75	±0.75	SMA(M)-(F)
IHPA-D1-50-XX-12.4-A	DC-12.4	1.20	Fig 1	50 ¹⁾	N.A	±0.5	±0.6	±0.80	±0.8	SMA(M)-(F)
IHPA-D1-50-XX-18-A	DC-18	1.25	Fig 1	50 ¹⁾	N.A	±1.0	±1.0	±1.0	±1.0	SMA(M)-(F)
IHPA-D1-50-XX-26.5-A	DC-26.5	1.30	Fig 1	50 ¹⁾	N.A	+2.5/-1.0	+1.5/-1.0	+1.5/-1.0	+1.5/-1.0	SMA(M)-(F)

1) Average Power at 25°C ambient temperature, derated linearly to 5W @125°C. Peak Power is 5kW(5us pulse width with 1% duty cycle)

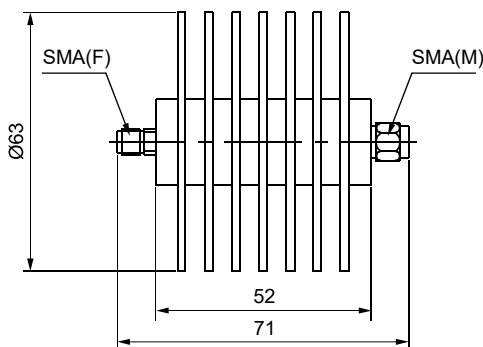

Fig 1

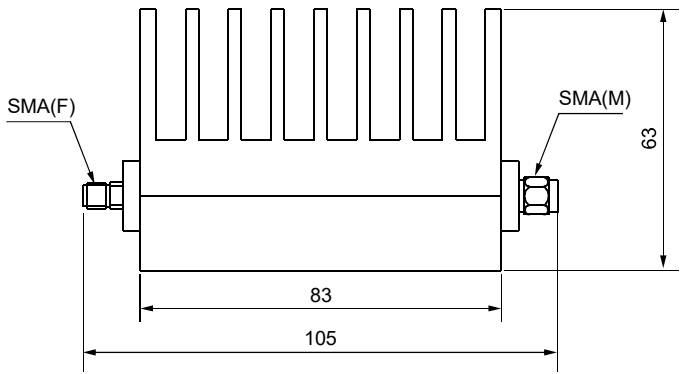

Fig 2

Imported SMA High Power Attenuators, 50W

Frequency: DC ~ 26.5 GHz

P/N: IHPA-??-50.. Series

INDE[®]

VNA Plot for IHPA-D1-50-10-18-A Attenuator (10dB/50W/18GHz)

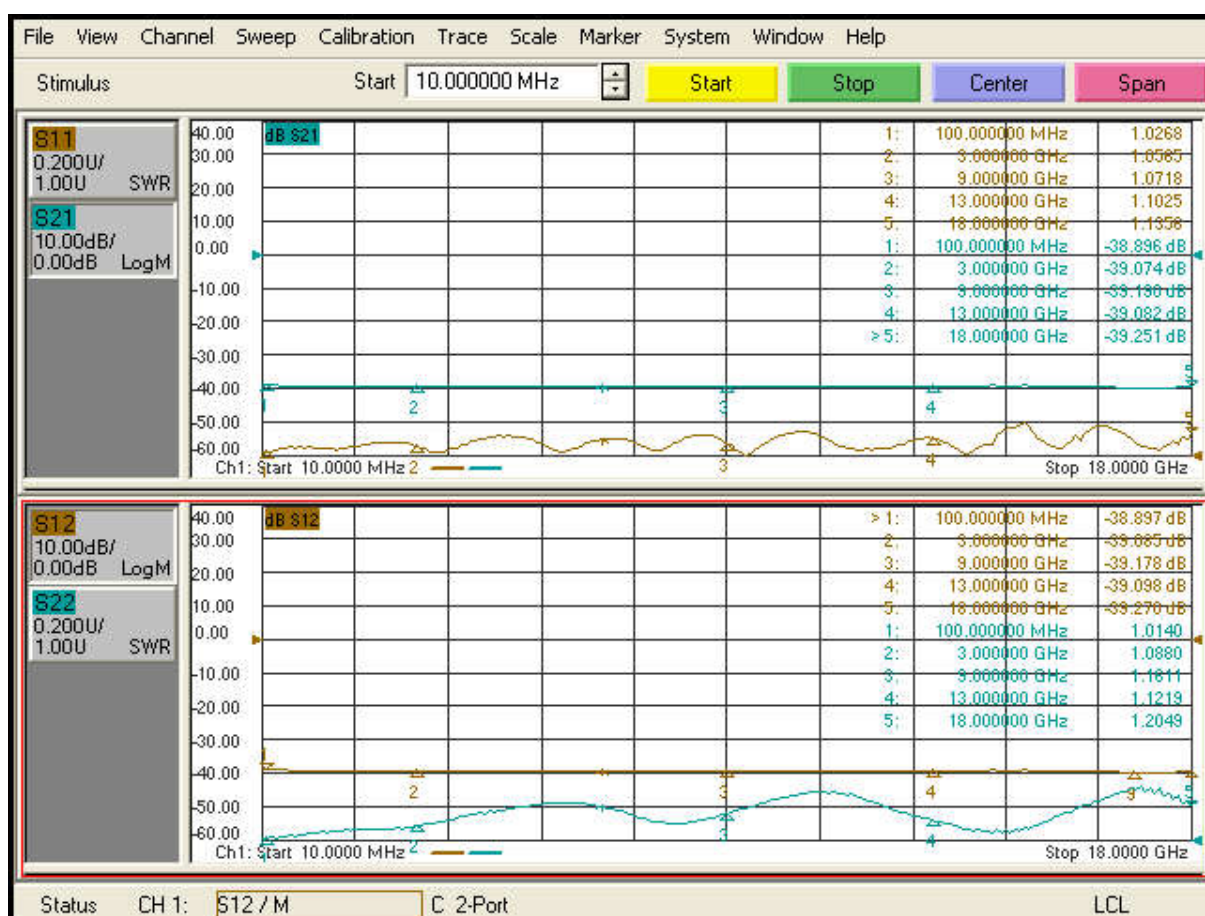

Imported N Attenuators, 2W

INDE®

Frequency: DC ~ 18 GHz

P/N: IHPA-??-2.. Series



Impedance : 50 Ω

Operating Temp : -55°C ~125°C

Ordering Code	Freq. (GHz)	VSWR (max)	Figure	Avg. Power (W)	Attenuation and Accuracy (dB)				Connector
					3/6	10/20	30	40	
IHPA-T3-2-XX-4-N	DC-4	1.20	Fig 3	2 ¹⁾	±0.4	±0.5	±0.6	±0.6	N(M)-(F)
IHPA-T2-2-XX-4-A	DC-4	1.10	Fig 2	2 ¹⁾	±0.3	±0.3	±0.3	±0.5	N(M)-(F)
IHPA-T1-2-XX-8-N-A	DC-8	1.20	Fig 1	2 ¹⁾	±0.5	±0.4	±0.5	±0.6	N(M)-(F)
IHPA-T2-2-XX-8-A	DC-8	1.15	Fig 2	2 ¹⁾	-0.3/+0.6	-0.3/+0.6	-0.3/+0.6	+0.6	N(M)-(F)
IHPA-T1-2-XX-12.4-N-A	DC-12.4	1.25	Fig 1	2 ¹⁾	±0.7	±0.7	±0.7	±0.75	N(M)-(F)
IHPA-T2-2-XX-12.4-A	DC-12.4	1.20	Fig 2	2 ¹⁾	-0.3/+0.6	-0.3/+0.6	-0.3/+0.6	+0.75	N(M)-(F)
IHPA-T1-2-XX-18-N-A	DC-18	1.30	Fig 1	2 ¹⁾	-0.4/+1.2	±1.0	±1.2	±1.2	N(M)-(F)
IHPA-T2-2-XX-18-A	DC-18	1.30	Fig 2	2 ¹⁾	-0.3/+0.8	-0.3/+0.8	-0.3/+0.8	+1.2	N(M)-(F)

1) Av. Power @25°C amb. temperature, derated linearly to 0.5W @125°C. Peak Power is 0.5kW(5us pulse with 0.2% duty)

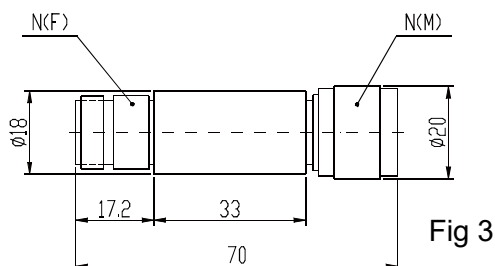
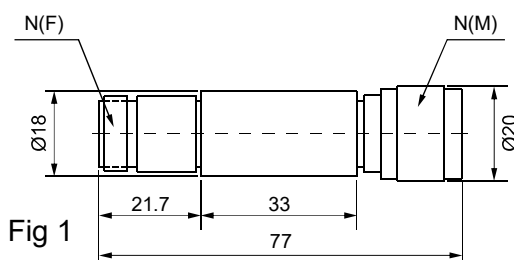
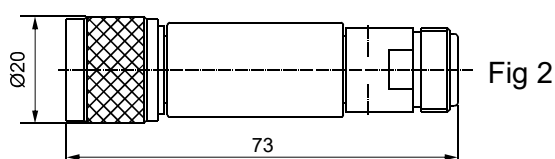

Cross reference is based on manufacturers datasheets and is indicative only. Customers have to verify themselves exact specifications. We accept no legal liability whatsoever for use of this cross reference by the customer. While the information, contained herein in this datasheet, has been carefully compiled to the best of our knowledge, nothing is intended as representation or warranty on our part and no statement herein shall be construed as recommendation to infringe existing patents. We accept no liability of whatsoever for any fault and errors in this datasheet. Contents of this datasheet and specifications of the products are subject to change without notice due to continuous improvement.

N14

Imported N Attenuators, 2W

Frequency: DC ~ 18 GHz

P/N: IHPA-??-2.. Series

INDE[®]

VNA Plot for IHPA-T1-2-XX-12.4-N Attenuator (40dB/2W/12.4GHz)

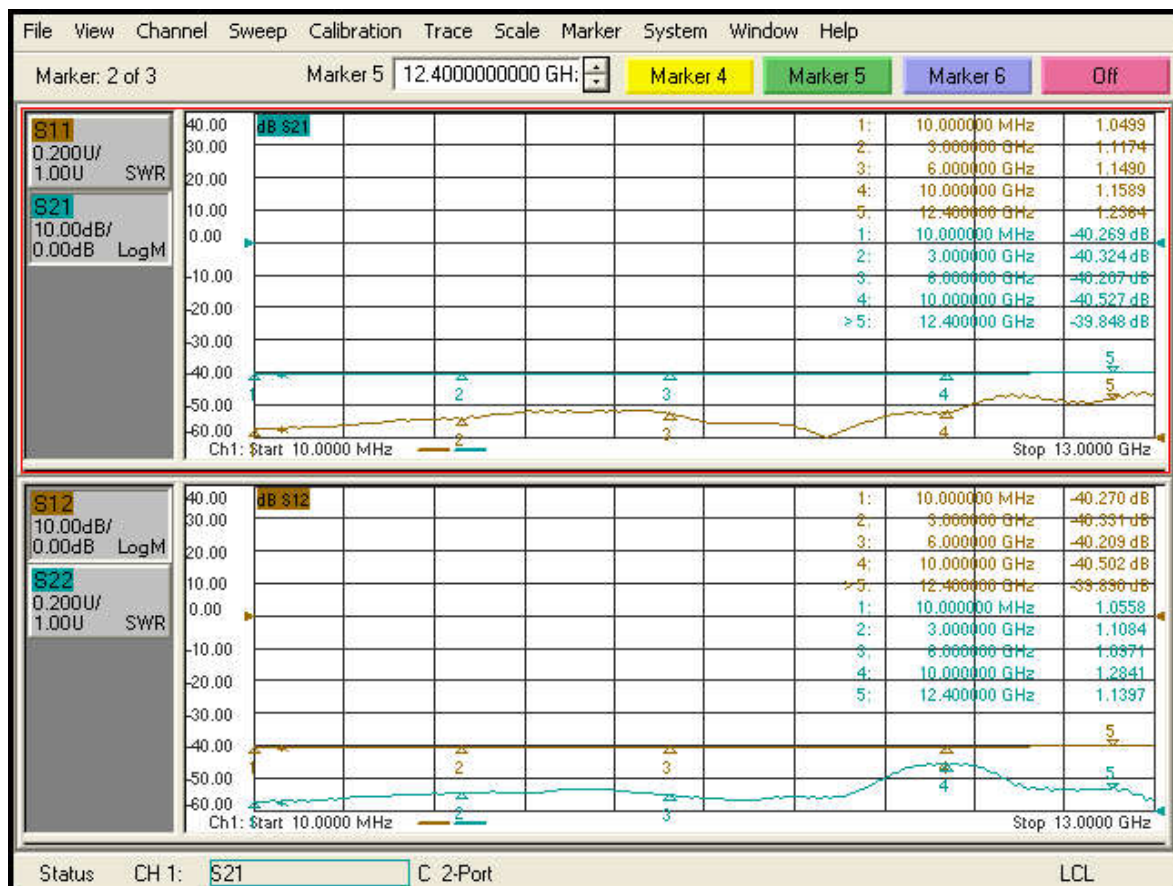

Cross reference is based on manufacturers datasheets and is indicative only. Customers have to verify themselves exact specifications. We accept no legal liability whatsoever for use of this cross reference by the customer. While the information, contained herein in this datasheet, has been carefully compiled to the best of our knowledge, nothing is intended as representation or warranty on our part and no statement herein shall be construed as recommendation to infringe existing patents. We accept no liability of whatsoever for any fault and errors in this datasheet. Contents of this datasheet and specifications of the products are subject to change without notice due to continuous improvement.

N14

Imported N Attenuators, 5W

INDE®

Frequency: DC ~ 18 GHz

P/N: IHPA-??-5.. Series



Impedance : 50 Ω

Operating Temp : -55°C ~125°C

Ordering Code	Freq. (GHz)	VSWR (max)	Figure	Avg. Power (W)	Attenuation and Accuracy (dB)						Connector
					3	6	10	20	30	40	
IHPA-T3-5-XX-4	DC-4	<1.10@1 GHz <1.15@2 GHz <1.20 @4 GHz	Fig 3	5 ¹⁾	±0.4	±0.4	±0.5	±0.5	±0.6	±0.6	N (M)-(F)
IHPA-T1-5-XX-8-N-A	DC-8	1.30	Fig 1	5 ²⁾	±0.5	±0.5	±0.4	±0.4	±0.5	±0.6	N (M)-(F)
IHPA-T2-5-XX-8-A	DC-8	1.15	Fig 2	5 ²⁾	-0.3/ +0.6	-0.3/ +0.6	-0.3/ +0.6	-0.3/ +0.6	-0.3/ +0.6	±0.6	N (M)-(F)
IHPA-T1-5-XX-12.4-N-A	DC-12.4	1.35	Fig 1	5 ²⁾	±0.7	±0.7	±0.7	±0.7	±0.7	±0.75	N (M)-(F)
IHPA-T2-5-XX-12.4-A	DC-12.4	1.20	Fig 2	5 ²⁾	-0.3/ +0.6	-0.3/ +0.6	-0.3/ +0.6	-0.3/ +0.6	-0.3/ +0.6	±0.75	N (M)-(F)
IHPA-T1-5-XX-18-N-A	DC-18	1.40	Fig 1	5 ²⁾	-0.4/ +1.2	-0.4/ +1.2	±1.0	±1.2	±1.2	±1.2	N (M)-(F)
IHPA-T2-5-XX-18-A	DC-18	1.30	Fig 2	5 ²⁾	-0.3/ +0.8	-0.3/ +0.8	-0.3/ +0.8	-0.3/ +0.8	-0.3/ +1.0	±1.2	N (M)-(F)

1) Av. Power @25°C ambient temperature, derated linearly to 0.5W @125°C. Peak Power is 1kW (5us pulse width with 0.5% duty)

2) Av. Power @25°C ambient temperature, derated linearly to 0.5W @125°C. Peak Power is 1kW (5us pulse width with 0.25% duty)

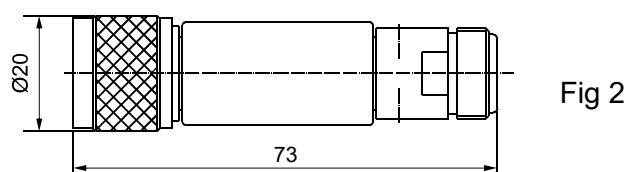

Fig 2

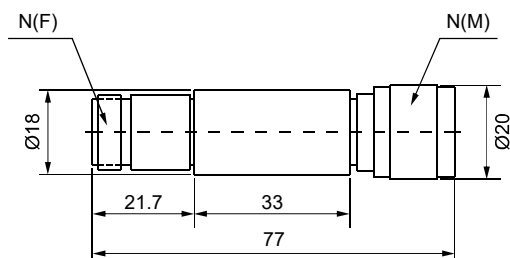

Fig 1

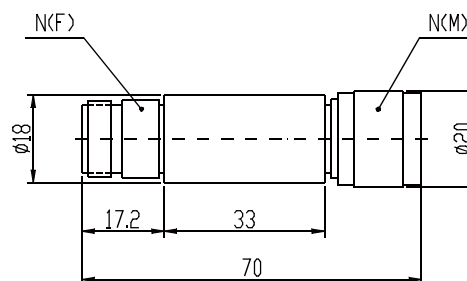

Fig 3

N15

Cross reference is based on manufacturers datasheets and is indicative only. Customers have to verify themselves exact specifications. We accept no legal liability whatsoever for use of this cross reference by the customer. While the information, contained herein in this datasheet, has been carefully compiled to the best of our knowledge, nothing is intended as representation or warranty on our part and no statement herein shall be construed as recommendation to infringe existing patents. We accept no liability of whatsoever for any fault and errors in this datasheet. Contents of this datasheet and specifications of the products are subject to change without notice due to continuous improvement.

Imported N Attenuators, 5W

Frequency: DC ~ 18 GHz

P/N: IHPA-??-5.. Series

INDE[®]

VNA Plot for IHPA-T1-5-03-8-N Attenuator (3dB/5W/8GHz)

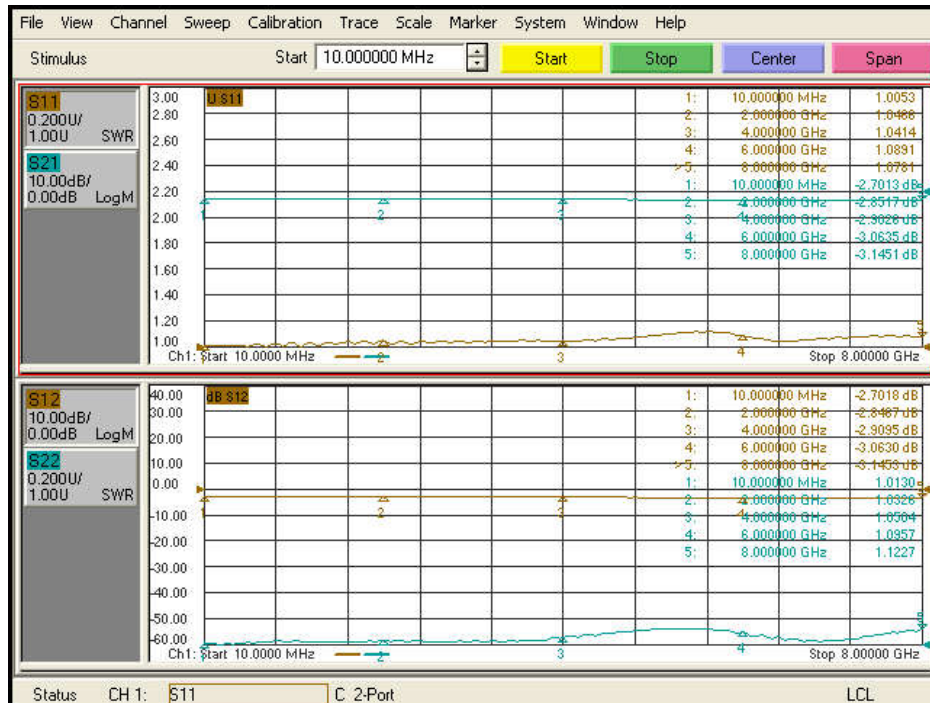

VNA Plot for IHPA-T1-5-10-8-N Attenuator (10dB/5W/8GHz)

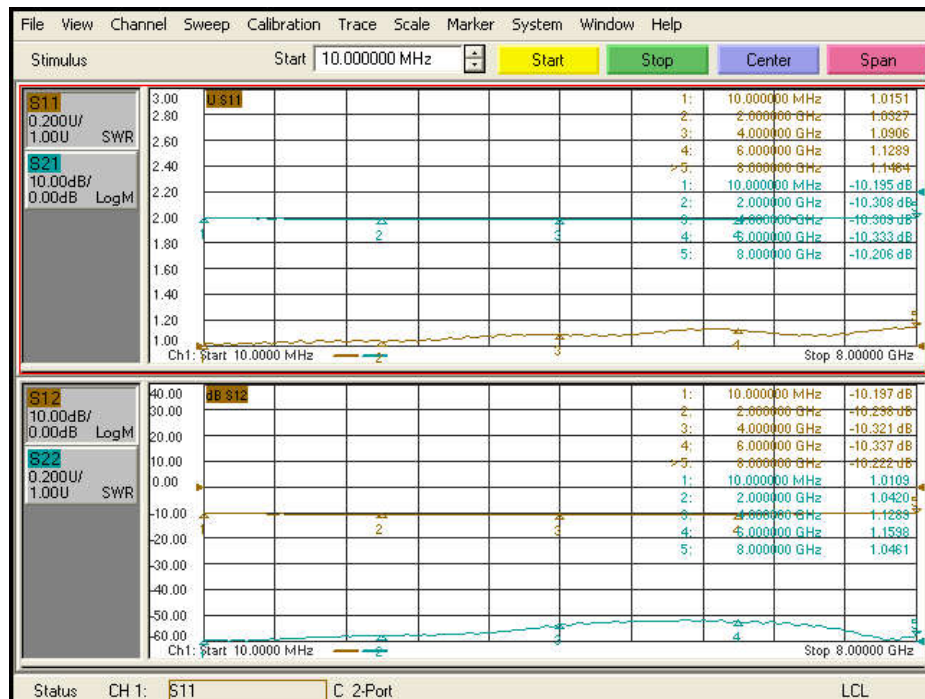

N15

Cross reference is based on manufacturers datasheets and is indicative only. Customers have to verify themselves exact specifications. We accept no legal liability whatsoever for use of this cross reference by the customer. While the information, contained herein in this datasheet, has been carefully compiled to the best of our knowledge, nothing is intended as representation or warranty on our part and no statement herein shall be construed as recommendation to infringe existing patents. We accept no liability of whatsoever for any fault and errors in this datasheet. Contents of this datasheet and specifications of the products are subject to change without notice due to continuous improvement.

Imported N Attenuators, 10W

INDE®

Frequency: DC ~ 18 GHz

P/N: IHPA-??-10.. Series



Impedance : 50 Ω

Operating Temp : -55°C ~125°C

Ordering Code	Freq. (GHz)	VSWR (max)	Figure	Avg. Power (W)	Attenuation and Accuracy (dB)						Connector
					3	6	10	20	30	40	
IHPA-D2-10-XX-4-N	DC-4	<1.15@3 GHz <1.20 @4 GHz	Fig 2	10 ¹⁾	±0.5	±0.5	±0.6	±0.6	±0.6	±0.8	N (M)-(F)
IHPA-D3-10-XX-4	DC-4	1.15	Fig 2	10 ²⁾	±0.3	±0.3	±0.3	±0.3	±0.3	±0.3	N (M)-(F)
IHPA-D1-10-XX-8-N	DC-8	1.30	Fig 1	10 ²⁾	/	/	±0.5	±0.5	±0.5	±0.6	N (M)-(F)
IHPA-D3-10-XX-8	DC-8	1.20	Fig 2	10 ²⁾	-0.3/ +0.6	-0.3/ +0.6	-0.3/ +0.6	-0.3/ +0.6	-0.3/ +0.6	-0.3/ +0.6	N (M)-(F)
IHPA-D1-10-XX-12.4-N	DC-12.4	1.35	Fig 1	10 ²⁾	/	/	±1.0	±1.0	±1.0	±1.0	N (M)-(F)
IHPA-D3-10-XX-12.4	DC-12.4	1.25	Fig 2	10 ²⁾	-0.3/ +0.6	-0.3/ +0.6	-0.3/ +0.6	-0.3/ +0.6	-0.3/ +0.6	-0.3/ +0.6	N (M)-(F)
IHPA-D1-10-XX-18-N	DC-18	1.40	Fig 1	10 ²⁾	/	/	±1.0	±1.0	±1.2	±1.2	N (M)-(F)
IHPA-D3-10-XX-18	DC-18	1.30	Fig 2	10 ²⁾	-0.3/ +0.8	-0.3/ +0.8	-0.3/ +0.8	-0.3/ +0.8	-0.3/ +1.0	-0.3/ +1.0	N (M)-(F)

1) Average Power at 25°C ambient temperature, derated linearly to 1W @125°C. Peak Power is 1kW(5us pulse width with 1% duty cycle)

2) Average Power at 25°C ambient temperature, derated linearly to 1W @125°C. Peak Power is 1kW(5us pulse width with 0.5% duty cycle)

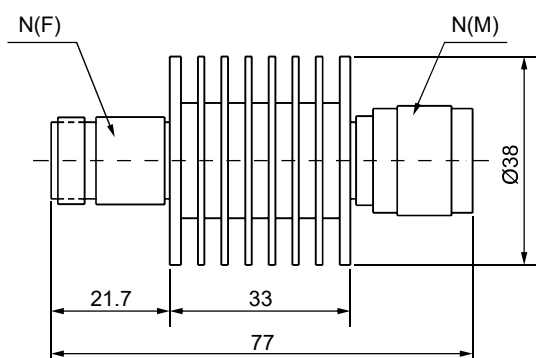

Fig 1

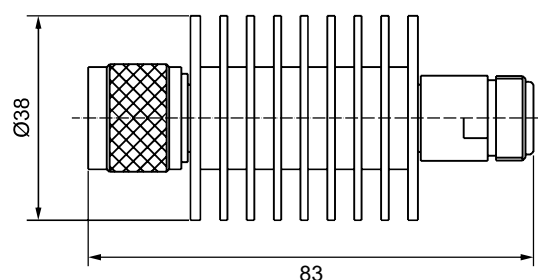

Fig 2

Cross reference is based on manufacturers datasheets and is indicative only. Customers have to verify themselves exact specifications. We accept no legal liability whatsoever for use of this cross reference by the customer. While the information, contained herein in this datasheet, has been carefully compiled to the best of our knowledge, nothing is intended as representation or warranty on our part and no statement herein shall be construed as recommendation to infringe existing patents. We accept no liability of whatsoever for any fault and errors in this datasheet. Contents of this datasheet and specifications of the products are subject to change without notice due to continuous improvement.

N16

Imported N Attenuators, 10W

Frequency: DC ~ 18 GHz

P/N: IHPA-??-10.. Series

INDE[®]

VNA Plot for IHPA-D1-10-10-18-N Attenuator (10dB/10W/18GHz)

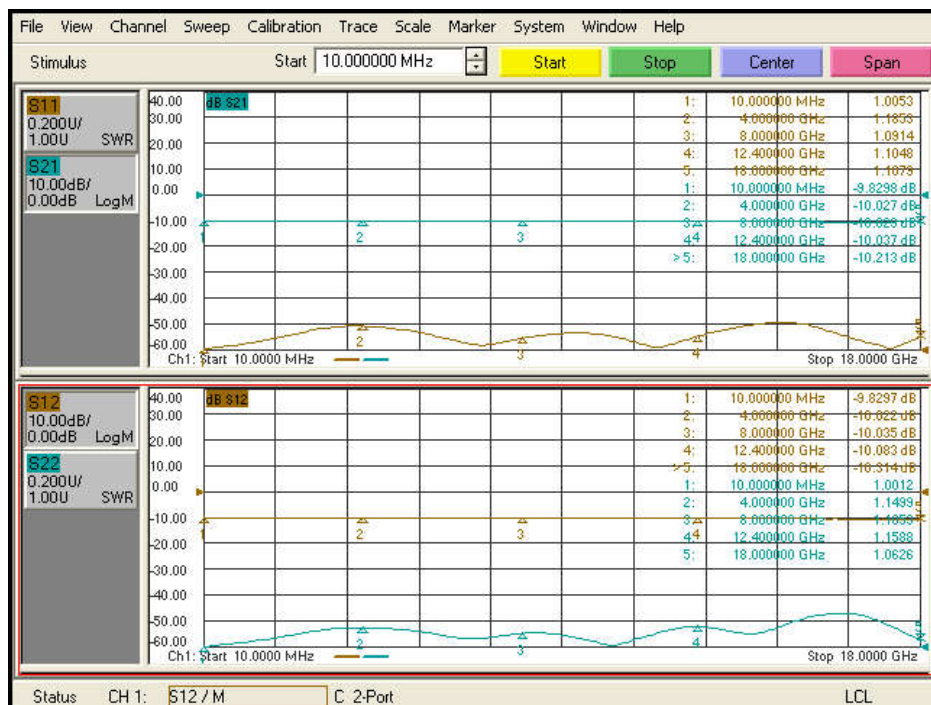

VNA Plot for IHPA-D1-10-10-8-N Attenuator (10dB/10W/8GHz)



Cross reference is based on manufacturers datasheets and is indicative only. Customers have to verify themselves exact specifications. We accept no legal liability whatsoever for use of this cross reference by the customer. While the information, contained herein in this datasheet, has been carefully compiled to the best of our knowledge, nothing is intended as representation or warranty on our part and no statement herein shall be construed as recommendation to infringe existing patents. We accept no liability of whatsoever for any fault and errors in this datasheet. Contents of this datasheet and specifications of the products are subject to change without notice due to continuous improvement.

N16

Imported N High Power Attenuators, 25W

INDE®

Frequency: DC ~ 18 GHz

P/N: IHPA-??-25.. Series



Impedance : 50 Ω

Operating Temp : -55°C ~125°C

Ordering Code	Freq. (GHz)	VSWR (max)	Figure	Avg. Power (W)	Attenuation and Accuracy (dB)						Connector
					3	6	10	20	30	40	
IHPA-D2-25-XX-4-N-A	DC-4	<1.05@1 GHz <1.10 @2 GHz <1.15@3 GHz <1.25 @4 GHz	Fig 2	25 ¹⁾	±0.5	±0.5	±0.6	±0.6	±0.6	±1.0	N(M)-(F)
IHPA-D1-25-XX-4-N-A	DC-4	1.20	Fig 1	25 ²⁾	/	/	±0.4	±0.4	±0.4	±0.75	N(M)-(F)
IHPA-D1-25-XX-8-N-A	DC-8	1.30	Fig 1	25 ²⁾	/	/	±0.5	±0.5	±0.5	±0.75	N(M)-(F)
IHPA-D1-25-XX-12.4-N-A	DC-12.4	1.35	Fig 1	25 ²⁾	/	/	±1.0	±1.0	±1.0	±1.0	N(M)-(F)
IHPA-D1-25-XX-18-N-A	DC-18	1.40	Fig 1	25 ²⁾	/	/	±1.0	±1.0	±1.25	±1.25	N(M)-(F)

1) Average Power at 25°C ambient temperature, derated linearly to 2.5W @125°C. Peak Power is 1kW(5us pulse width with 2.5% duty cycle)

2) Average Power at 25°C ambient temperature, derated linearly to 2.5W @125°C. Peak Power is 1kW(5us pulse width with 1.25% duty cycle)

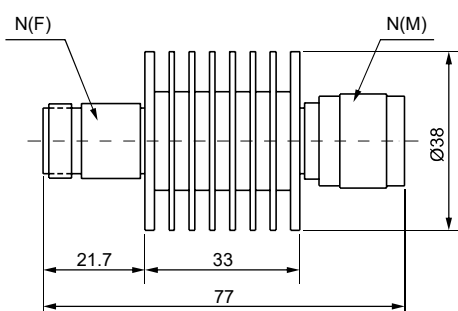

Fig 1

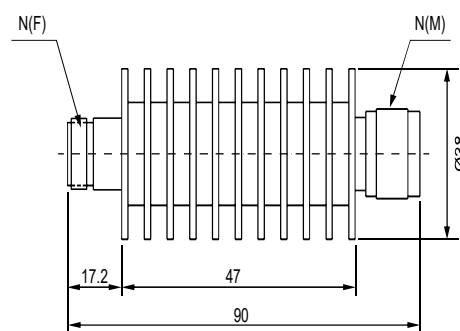

Fig 2

N17

Cross reference is based on manufacturers datasheets and is indicative only. Customers have to verify themselves exact specifications. We accept no legal liability whatsoever for use of this cross reference by the customer. While the information, contained herein in this datasheet, has been carefully compiled to the best of our knowledge, nothing is intended as representation or warranty on our part and no statement herein shall be construed as recommendation to infringe existing patents. We accept no liability of whatsoever for any fault and errors in this datasheet. Contents of this datasheet and specifications of the products are subject to change without notice due to continuous improvement.

Imported N High Power Attenuators, 25W

Frequency: DC ~ 18 GHz

P/N: IHPA-??-25.. Series

INDE[®]

VNA Plot for IHPA-D1-25-20-4-N-A Attenuator (20dB/25W/4GHz)

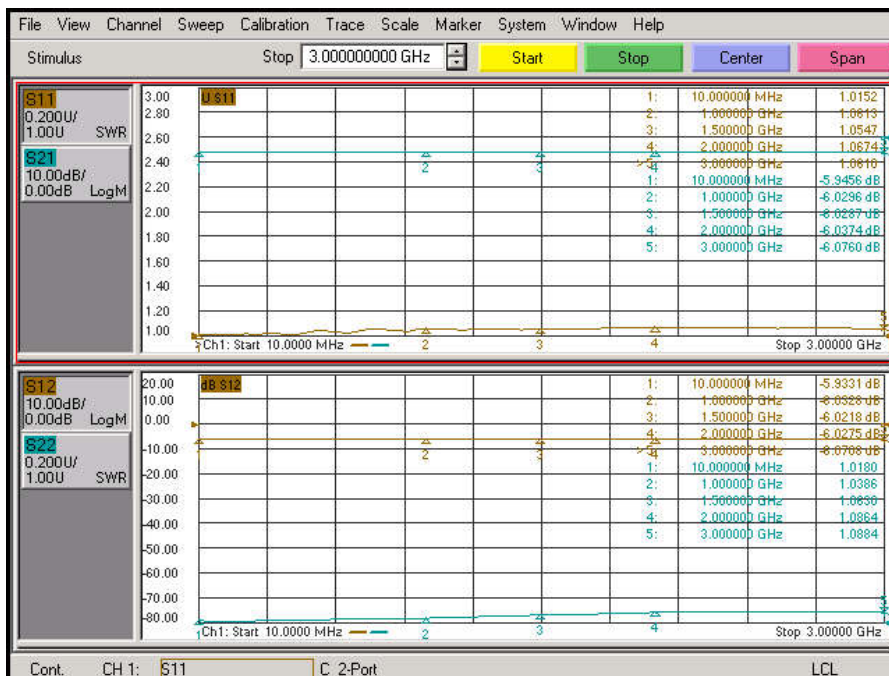

VNA Plot for IHPA-D1-25-20-18-N-A Attenuator (20dB/25W/18GHz)

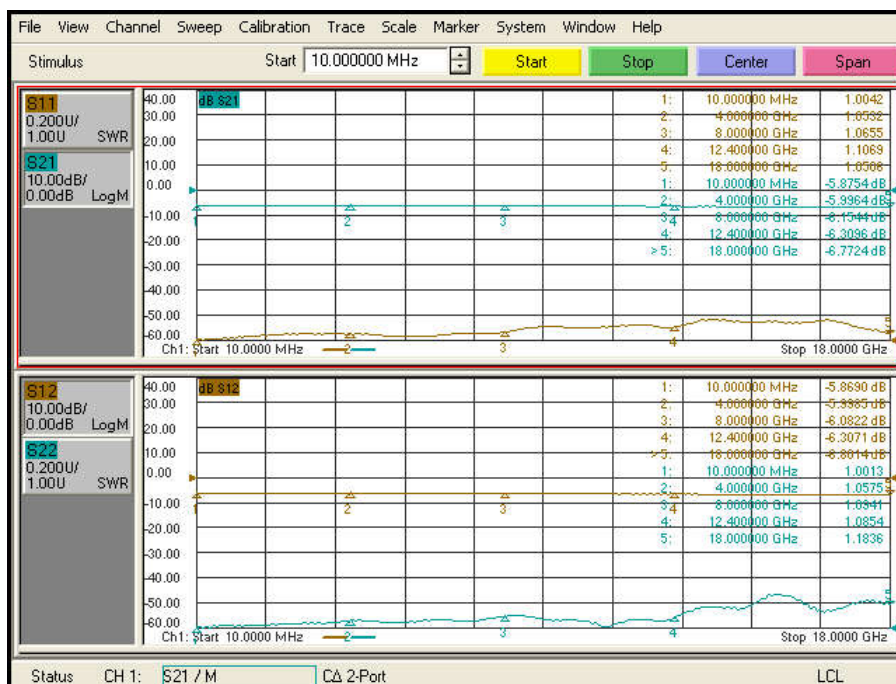

Imported N High Power Attenuators, 50W

INDE®

Frequency: DC ~ 18 GHz

P/N: IHPA-??-50.. Series



Impedance : 50 Ω

Operating Temp : -55°C ~125°C

Ordering Code	Freq. (GHz)	VSWR (max)	Figure	Avg. Power (W)	Attenuation and Accuracy (dB)						Connector
					3	6	10	20	30	40	
IHPA-D1-50-XX-4-N-C	DC-4	<1.10 @2.5 GHz <1.15 @4 GHz	Fig 1	50 ¹⁾	±0.3	±0.3	±0.3	±0.3	±0.4	±0.5	N (M)-(F)
IHPA-D1-50-XX-8-N-C	DC-8	1.30	Fig 1	50 ¹⁾	±0.6	±0.6	±0.6	±0.6	±0.75	±1.0	N (M)-(F)
IHPA-D2-50-XX-18-N-C	DC-18	1.35	Fig 2	50 ¹⁾	-1/ +1.5	-1/ +1.5	-1/ +1.5	-1/ +1.5	±1.0	-1/ +1.5	N (M)-(F)

1) Average Power at 25°C ambient temperature, derated linearly to 5W @125°C. Peak Power is 5kW(5us pulse width with 1% duty cycle)

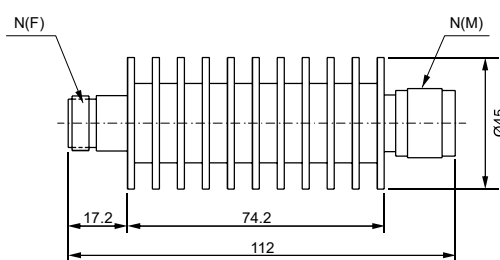

Fig 1

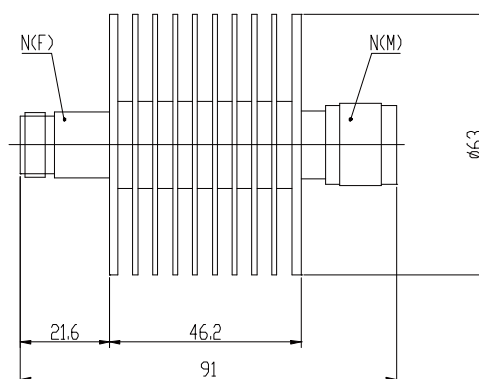

Fig 2

Cross reference is based on manufacturers datasheets and is indicative only. Customers have to verify themselves exact specifications. We accept no legal liability whatsoever for use of this cross reference by the customer. While the information, contained herein in this datasheet, has been carefully compiled to the best of our knowledge, nothing is intended as representation or warranty on our part and no statement herein shall be construed as recommendation to infringe existing patents. We accept no liability of whatsoever for any fault and errors in this datasheet. Contents of this datasheet and specifications of the products are subject to change without notice due to continuous improvement.

N18

Imported N High Power Attenuators, 50W

Frequency: DC ~ 18 GHz

P/N: IHPA-??-50.. Series

INDE®

VNA Plot for IHPA-D1-50-10-8-N Attenuator (10dB/50W/8GHz)



VNA Plot for IHPA-D3-50-06-4-A Attenuator (6dB/50W/4GHz)



Cross reference is based on manufacturers datasheets and is indicative only. Customers have to verify themselves exact specifications. We accept no legal liability whatsoever for use of this cross reference by the customer. While the information, contained herein in this datasheet, has been carefully compiled to the best of our knowledge, nothing is intended as representation or warranty on our part and no statement herein shall be construed as recommendation to infringe existing patents. We accept no liability of whatsoever for any fault and errors in this datasheet. Contents of this datasheet and specifications of the products are subject to change without notice due to continuous improvement.

N18

Imported N High Power Attenuators, 100W

INDE®

Frequency: DC ~ 18 GHz

P/N: IHPA-??-100.. Series



Impedance : 50 Ω

Operating Temp : -55°C ~125°C

Ordering Code	Freq. (GHz)	VSWR (max)	Figure	Avg. Power (W)	Attenuation and Accuracy (dB)						Connector
					3	6	10	20	30	40	
IHPA-W1-100-XX-2.5-N-B	DC-2.5	1.15	Fig 1	100 ¹⁾	±0.4	±0.4	±0.3	±0.3	±0.3	±0.3	N (M)-(F)
IHPA-D2-100-XX-4-A	DC-4	<1.15@1 GHz <1.20 @2 GHz <1.30@3 GHz <1.35 @4 GHz	Fig 3	100 ²⁾	/	/	±0.75	±0.75	±0.75	±0.75	N (M)-(F)
IHPA-W1-100-XX-4-N-B	DC-4	1.20	Fig 1	100 ¹⁾	±0.6	±0.6	±0.5	±0.5	±0.5	±0.5	N (M)-(F)
IHPA-W1-100-XX-8-N-B	DC-8	1.35	Fig 1	100 ¹⁾	/	/	±1.0	±0.75	±0.75	±0.75	N (M)-(F)
IHPA-D1-100-XX-18-C	DC-18	1.40	Fig 2	100 ²⁾	±0.8	±1.0	-2.0/ +3.0	/	-2.0/ +2.5	±2.0	N(M)-(F)
IHPA-D1-100-XX-18	DC-18	1.45	Fig 4	100 ²⁾	-1.0/ +2.0	-1.0/ +3.0	-2.0/ +2.5	-1.5/ +2.5	-1.2/ +2.0	-1.2/ +2.0	N(M)-(F)

- 1) Av. Power @25°C amb. temperature, derated linearly to 10W @125°C. Peak Power is 5kW (5us pulse with 2% duty)
 2) Av. Power @25°C amb. temperature, derated linearly to 10W @125°C. Peak Power is 10kW (5us pulse with 1% duty)

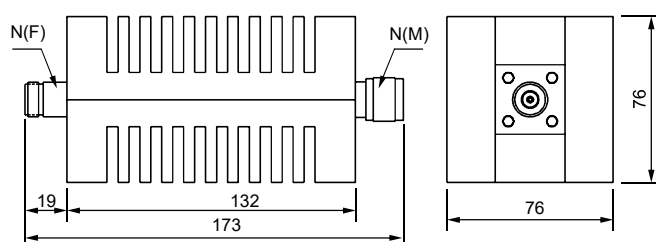

Fig 1

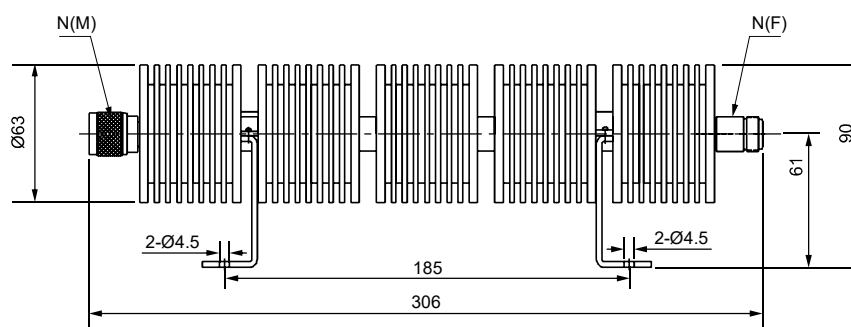

Fig 2

N19

Cross reference is based on manufacturers datasheets and is indicative only. Customers have to verify themselves exact specifications. We accept no legal liability whatsoever for use of this cross reference by the customer. While the information, contained herein in this datasheet, has been carefully compiled to the best of our knowledge, nothing is intended as representation or warranty on our part and no statement herein shall be construed as recommendation to infringe existing patents. We accept no liability of whatsoever for any fault and errors in this datasheet. Contents of this datasheet and specifications of the products are subject to change without notice due to continuous improvement.

Imported N High Power Attenuators, 100W

Frequency: DC ~ 18 GHz

P/N: IHPA-??-100.. Series

INDE[®]

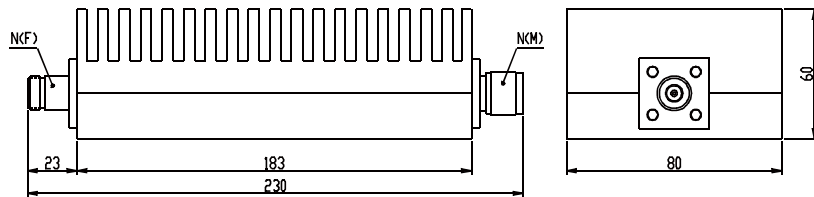

Fig 3

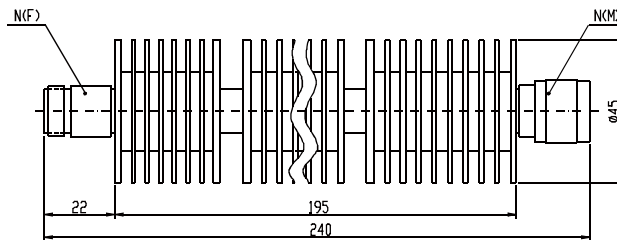
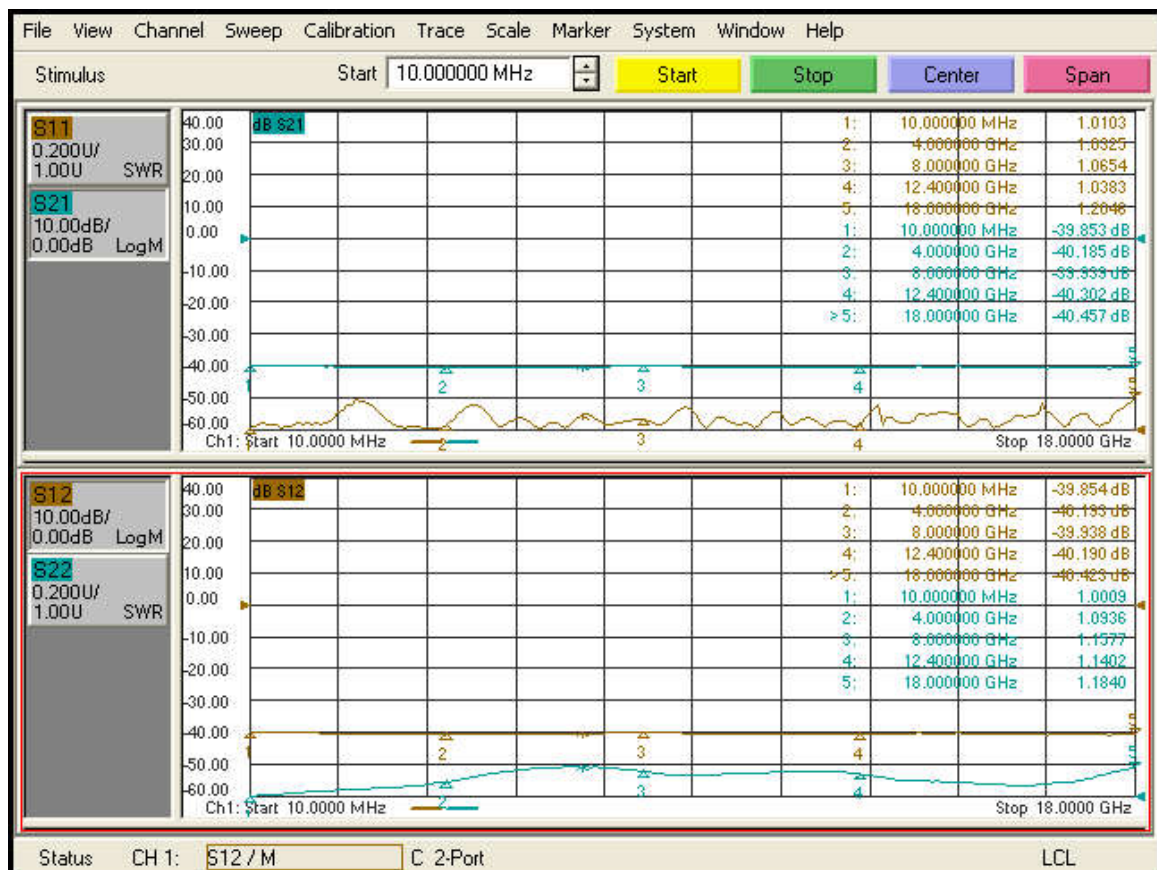

Fig 4

VNA Plot for IHPA-D1-100-40-18-C Attenuator (40dB/100W/18GHz)



Imported N High Power Attenuators, 150W

INDE®

Frequency: DC ~ 18 GHz

P/N: IHPA-??-150.. Series

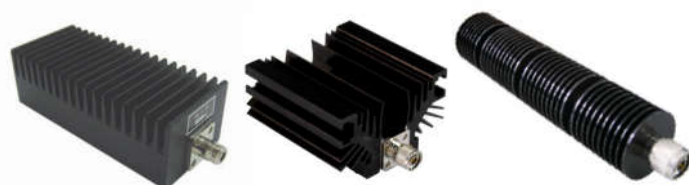

Impedance : 50 Ω

Operating Temp : -55°C ~125°C

Ordering Code	Freq. (GHz)	VSWR (max)	Figure	Avg. Power (W)	Attenuation and Accuracy (dB)						Connector
					3	6	10	20	30	40	
IHPA-W1-150-XX-2.5-A	DC-2.5	1.15	Fig 1	150 ¹⁾	±0.4	±0.4	±0.3	±0.3	±0.3	±0.3	N (M)-(F)
IHPA-D2-150-XX-4-A	DC-4	<1.15@1 GHz <1.20@2 GHz <1.35@3 GHz <1.40@4 GHz	Fig 3	150 ¹⁾	/	/	±1.5	±1.5	±1.0	±1.0	N (M)-(F)
IHPA-W1-150-XX-4-N-A	DC-4	1.20	Fig 1	150 ¹⁾	±0.6	±0.6	±0.5	±0.5	±0.5	±0.5	N (M)-(F)
IHPA-W1-150-XX-6-N-A	DC-6	1.30	Fig 1	150 ¹⁾	±0.8	±0.8	±0.75	±0.75	±0.75	±0.75	N (M)-(F)
IHPA-W1-150-XX-8-N-A	DC-8	1.35	Fig 1	150 ¹⁾	/	/	±1.0	±0.75	±0.75	±0.75	N (M)-(F)
IHPA-D1-150-XX-18-A	DC-18	1.45	Fig 2	150 ²⁾	-1.0/ +2.0	-0.7/ +3.5	-2.0/ +2.5	-3.0/ +2.0	-1.0/ +1.5	±1.5	N (M)-(F)

1) Average Power @25°C amb. temperature, derated linearly to 15W @125°C. Peak Power is 5kW(5us pulse with 3% duty)

2) Average Power @25°C amb. temperature, derated linearly to 15W @125°C. Peak Power is 1kW(5us pulse with 15% duty)

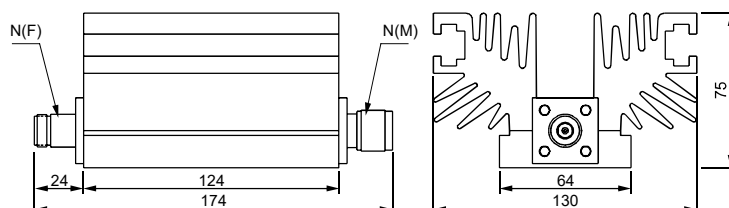

Fig 1

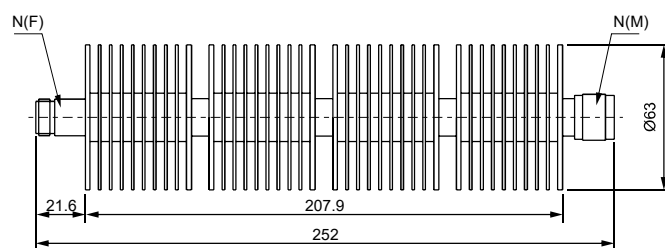

Fig 2

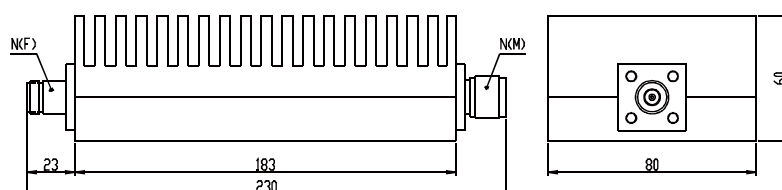

Fig 3

Cross reference is based on manufacturers datasheets and is indicative only. Customers have to verify themselves exact specifications. We accept no legal liability whatsoever for use of this cross reference by the customer. While the information, contained herein in this datasheet, has been carefully compiled to the best of our knowledge, nothing is intended as representation or warranty on our part and no statement herein shall be construed as recommendation to infringe existing patents. We accept no liability of whatsoever for any fault and errors in this datasheet. Contents of this datasheet and specifications of the products are subject to change without notice due to continuous improvement.

N20

Imported N High Power Attenuators, 150W

Frequency: DC ~ 18 GHz

P/N: IHPA-??-150.. Series

INDE[®]

VNA Plot for IHPA-D2-150-30-4 Attenuator (30dB/150W/4GHz)

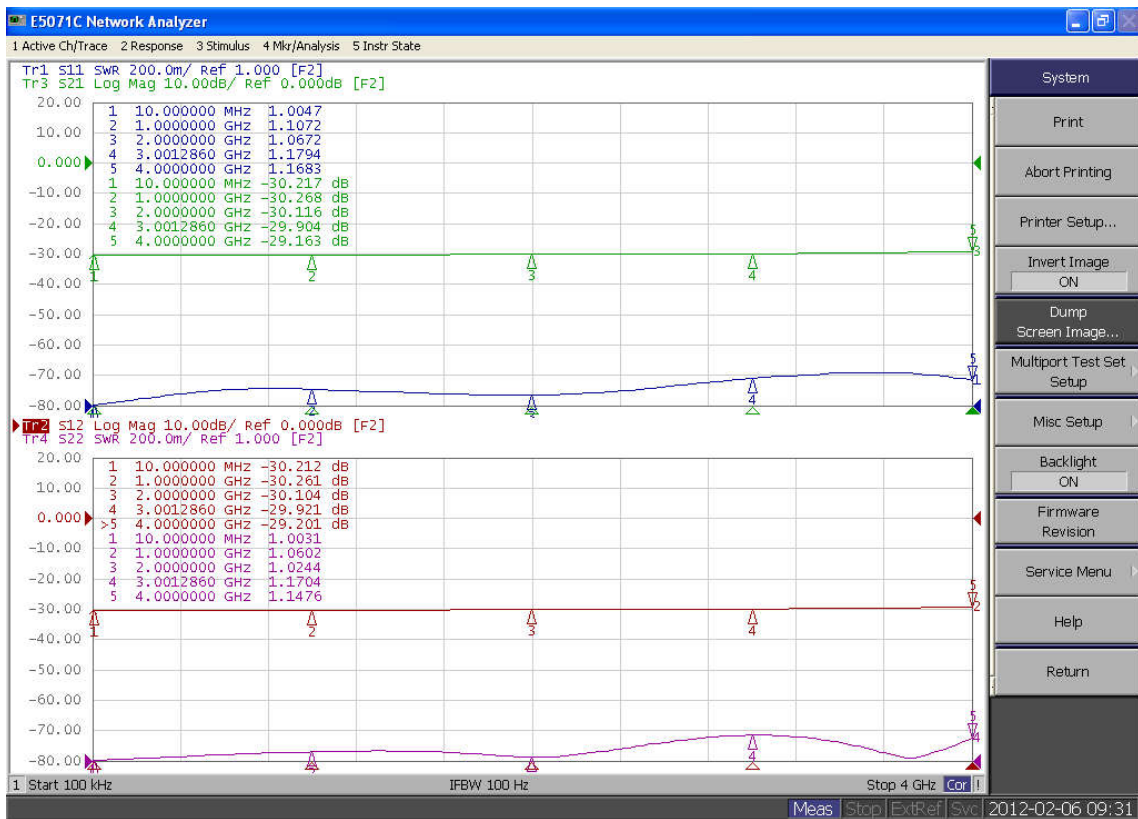

Cross reference is based on manufacturers datasheets and is indicative only. Customers have to verify themselves exact specifications. We accept no legal liability whatsoever for use of this cross reference by the customer. While the information, contained herein in this datasheet, has been carefully compiled to the best of our knowledge, nothing is intended as representation or warranty on our part and no statement herein shall be construed as recommendation to infringe existing patents. We accept no liability of whatsoever for any fault and errors in this datasheet. Contents of this datasheet and specifications of the products are subject to change without notice due to continuous improvement.

N20

Imported N High Power Attenuators, 250W

INDE®

Frequency: DC ~ 12.4 GHz

P/N: IHPA-??-250.. Series



Impedance : 50 Ω

Operating Temp : -55°C ~125°C

Ordering Code	Freq. (GHz)	VSWR (max)	Figure	Avg. Power (W)	Attenuation and Accuracy (dB)						Connector
					3	6	10	20	30	40	
IHPA-D2-250-XX-4	DC-4	<1.20@1.5 GHz <1.25@2 GHz <1.35@3 GHz <1.40@4 GHz	Fig 3	250 ²⁾	/	/	±1.5	±1.5	±1.0	±1.0	N (M)-(F)
IHPA-W2-250-XX-4-N-B	DC-4	<1.10@1.5 GHz <1.25@4 GHz	Fig 1	250 ¹⁾	/	/	±1.0	±0.5	±0.5	±0.5	N (M)-(F)
IHPA-W2-250-XX-6-N-B	DC-6	<1.25@5 GHz <1.30@6 GHz	Fig 1	250 ¹⁾	/	/	/	±0.6	±0.6	±0.6	N (M)-(F)
IHPA-W2-250-XX-8-N-B	DC-8	1.35	Fig 1	250 ¹⁾	/	/	/	±0.75	±0.75	±0.75	N (M)-(F)
IHPA-D1-150-XX-12.4	DC-12.4	1.40	Fig 2	250 ²⁾	/	/	-1.5/ +2.0	-2.5/ +1.0	±2.0	±2.0	N (M)-(F)

1) Average Power @25°C amb. temperature, derated linearly to 15W @125°C. Peak Power is 5kW(5us pulse with 5% duty)

2) Average Power @25°C amb. temperature, derated linearly to 15W @125°C. Peak Power is 10kW(5us pulse with 2.5% duty)

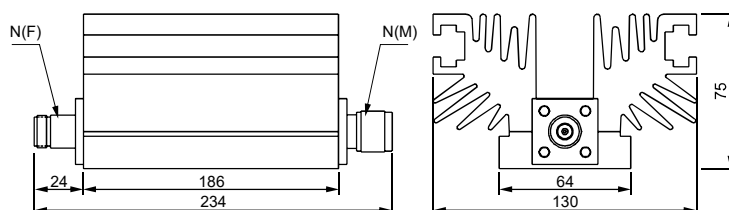

Fig 1

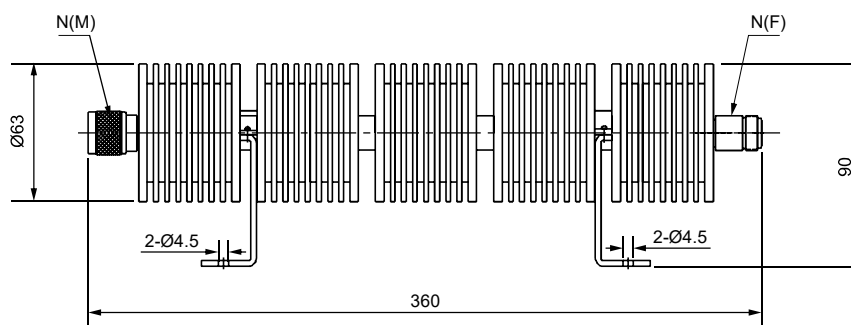

Fig 2

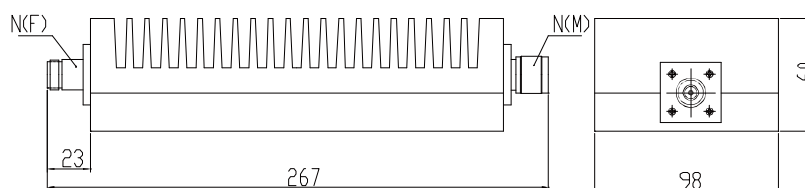

Fig 3

Cross reference is based on manufacturers datasheets and is indicative only. Customers have to verify themselves exact specifications. We accept no legal liability whatsoever for use of this cross reference by the customer. While the information, contained herein in this datasheet, has been carefully compiled to the best of our knowledge, nothing is intended as representation or warranty on our part and no statement herein shall be construed as recommendation to infringe existing patents. We accept no liability of whatsoever for any fault and errors in this datasheet. Contents of this datasheet and specifications of the products are subject to change without notice due to continuous improvement.

N20

Imported N High Power Attenuators, 250W

Frequency: DC ~ 12.4 GHz

P/N: IHPA-??-250.. Series

INDE[®]

VNA Plot for IHPA-W2-250-20-4-N-B Attenuator (20dB/250W/4GHz)

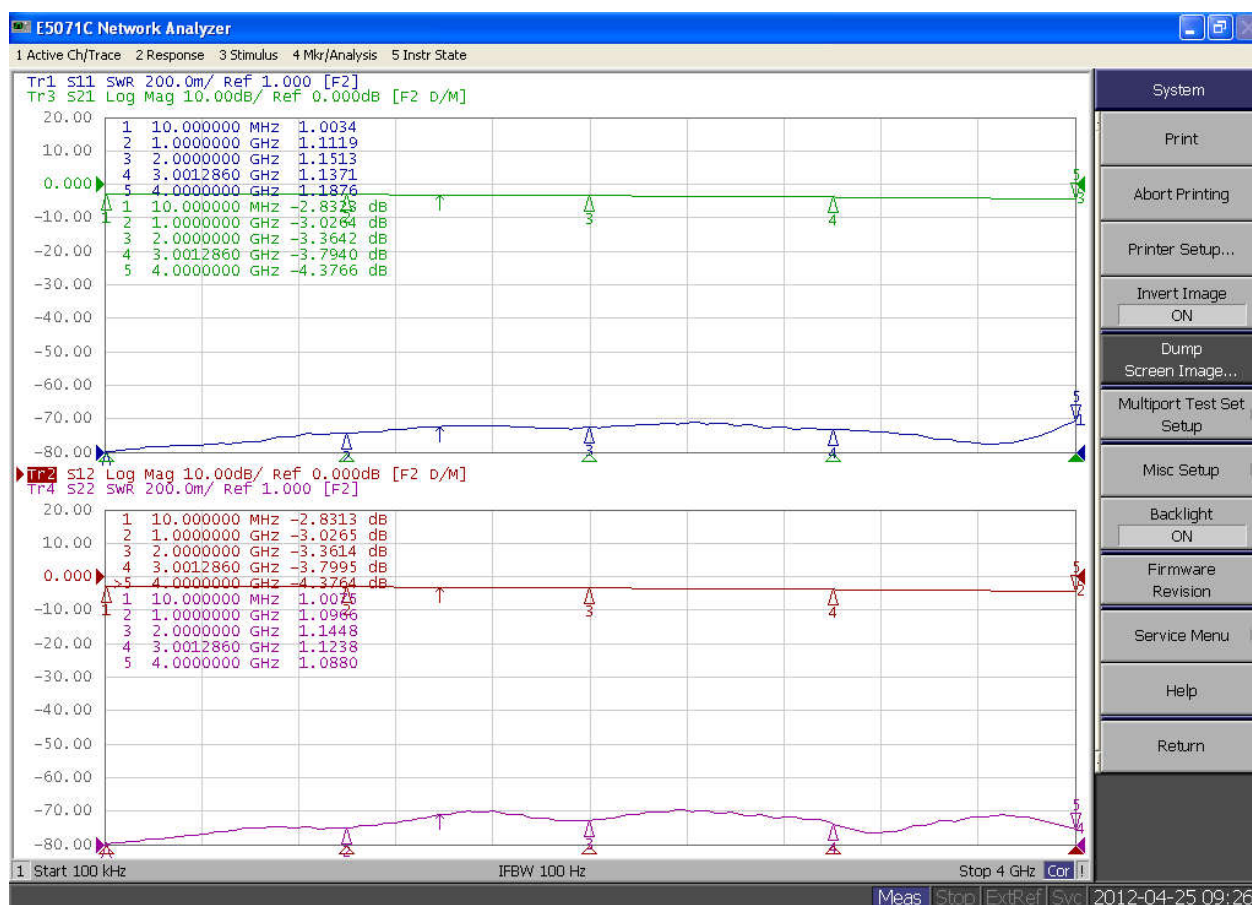

Cross reference is based on manufacturers datasheets and is indicative only. Customers have to verify themselves exact specifications. We accept no legal liability whatsoever for use of this cross reference by the customer. While the information, contained herein in this datasheet, has been carefully compiled to the best of our knowledge, nothing is intended as representation or warranty on our part and no statement herein shall be construed as recommendation to infringe existing patents. We accept no liability of whatsoever for any fault and errors in this datasheet. Contents of this datasheet and specifications of the products are subject to change without notice due to continuous improvement.

N20

Imported N High Power Attenuators, 300W

INDE®

Frequency: DC ~ 10 GHz

P/N: IHPA-??-300.. Series

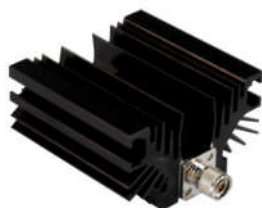

Impedance : 50 Ω

Operating Temp : -55°C ~125°C

Ordering Code	Freq. (GHz)	VSWR (max)	Figure	Avg. Power (W)	Attenuation and Accuracy (dB)					Connector
					10	20	30	40	50	
IHPA-D2-300-XX-4-B	DC-4	<1.2@1 GHz <1.25 @2 GHz <1.35@3 GHz <1.50 @4 GHz	Fig 1	300 ¹⁾	±2.0	±2.0	±1.5	±1.5	±1.5	N (M)-(F)
IHPA-W1-300-XX-4-N	DC-4	1.25	Fig 2	300 ²⁾	/	/	±0.5	±0.5	±0.5	N (M)-(F)
IHPA-W1-300-XX-8N	DC-8	1.40	Fig 2	300 ²⁾	/	/	±1.0	±1.0	±1.0	N (M)-(F)
IHPA-W1-300-XX-10	DC-10	1.45	Fig 2	300 ²⁾	/	/	±1.0	±1.0	±1.0	N (M)-(F)

1) Average Power @25°C amb. temperature, derated linearly to 30W @125°C. Peak Power is 10kW(5us pulse with 3% duty)

2) Average Power @25°C amb. temperature, derated linearly to 30W @125°C. Peak Power is 5kW(5us pulse with 6% duty)

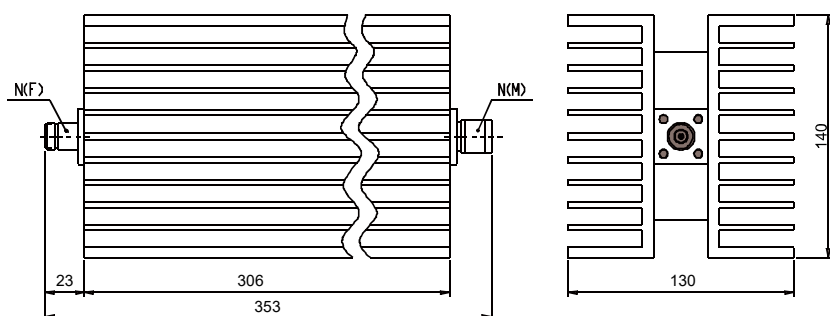

Fig 1

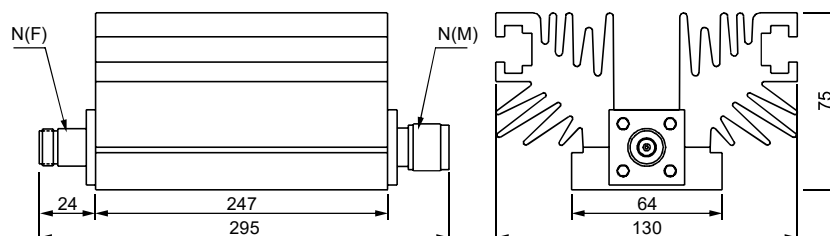

Fig 2

Cross reference is based on manufacturers datasheets and is indicative only. Customers have to verify themselves exact specifications. We accept no legal liability whatsoever for use of this cross reference by the customer. While the information, contained herein in this datasheet, has been carefully compiled to the best of our knowledge, nothing is intended as representation or warranty on our part and no statement herein shall be construed as recommendation to infringe existing patents. We accept no liability of whatsoever for any fault and errors in this datasheet. Contents of this datasheet and specifications of the products are subject to change without notice due to continuous improvement.

N20

Imported N High Power Attenuators, 300W

Frequency: DC ~ 10 GHz

P/N: IHPA-??-300.. Series

INDE[®]

VNA Plot for IHPA-W1-300-20-4-N Attenuator (20dB/300W/4GHz)

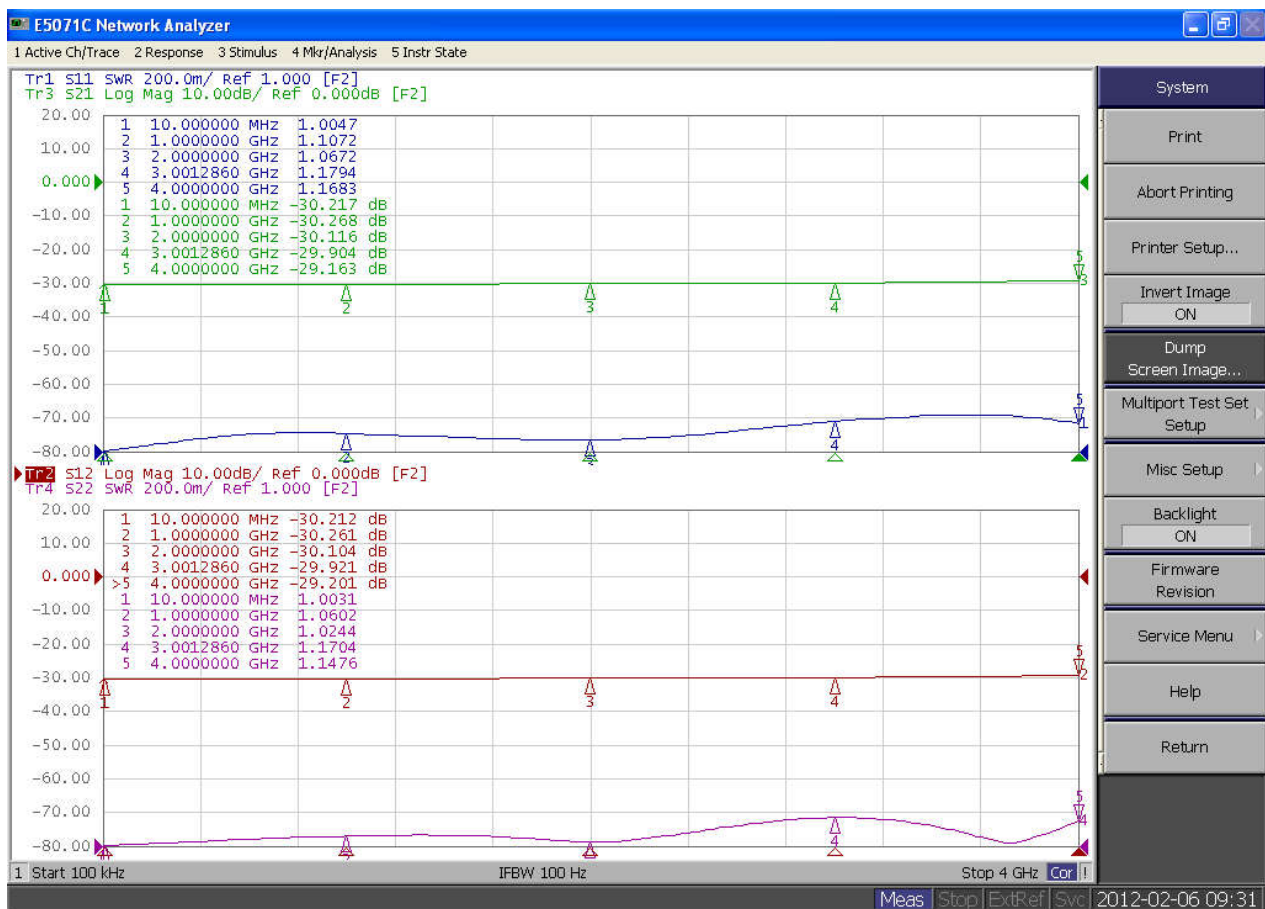

Cross reference is based on manufacturers datasheets and is indicative only. Customers have to verify themselves exact specifications. We accept no legal liability whatsoever for use of this cross reference by the customer. While the information, contained herein in this datasheet, has been carefully compiled to the best of our knowledge, nothing is intended as representation or warranty on our part and no statement herein shall be construed as recommendation to infringe existing patents. We accept no liability of whatsoever for any fault and errors in this datasheet. Contents of this datasheet and specifications of the products are subject to change without notice due to continuous improvement.

N20

Imported N High Power Attenuators, 500W

INDE®

Frequency: DC ~ 10 GHz

P/N: IHPA-??-500.. Series

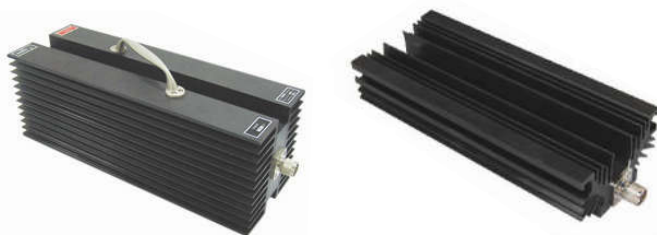

Impedance : 50 Ω

Operating Temp : -55°C ~125°C

Ordering Code	Freq. (GHz)	VSWR (max)	Figure	Avg. Power (W)	Attenuation and Accuracy (dB)					Connector
					10	20	30	40	50	
IHPA-D2-500-XX-4-B	DC-4	<1.2@1 GHz <1.25 @2 GHz <1.35@3 GHz <1.50 @4 GHz	Fig 1	500 ¹⁾	±2.0	±2.0	±1.5	±1.5	±1.5	N(M)-N(F)
IHPA-W1-500-XX-4-N	DC-4	1.25	Fig 2	500 ²⁾	-	-	±0.5	±0.5	±0.5	N(M)-N(F)
IHPA-W1-500-XX-6-N	DC-6	1.30	Fig 2	500 ²⁾	-	-	-	±0.6	±0.6	N(M)-N(F)
IHPA-W1-500-XX-8-N	DC-8	1.40	Fig 2	500 ²⁾	-	-	-	±0.8	±0.8	N(M)-N(F)
IHPA-W1-500-XX-10-N	DC-10	1.45	Fig 2	500 ²⁾	-	-	-	±1.0	±1.0	N(M)-N(F)

1) Average Power @25°C amb. temperature, derated linearly to 50W @125°C. Peak Power is 10kW(5us pulse with 5% duty)

2) Average Power @25°C amb. temperature, derated linearly to 50W @125°C. Peak Power is 5kW(5us pulse with 5% duty)

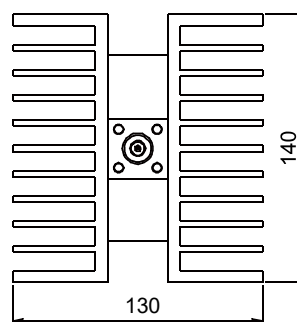
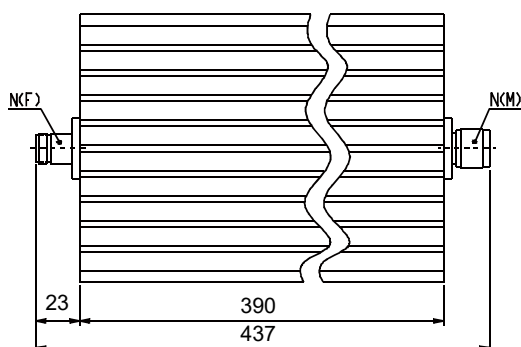

Fig 1

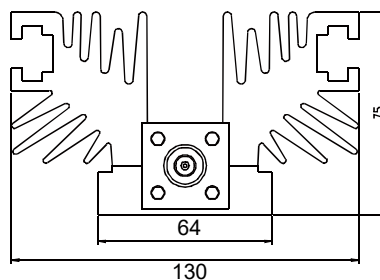
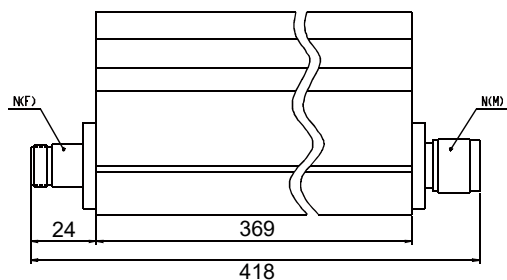

Fig 2

Cross reference is based on manufacturers datasheets and is indicative only. Customers have to verify themselves exact specifications. We accept no legal liability whatsoever for use of this cross reference by the customer. While the information, contained herein in this datasheet, has been carefully compiled to the best of our knowledge, nothing is intended as representation or warranty on our part and no statement herein shall be construed as recommendation to infringe existing patents. We accept no liability of whatsoever for any fault and errors in this datasheet. Contents of this datasheet and specifications of the products are subject to change without notice due to continuous improvement.

N20

Imported N High Power Attenuators, 500W

Frequency: DC ~ 10 GHz

P/N: IHPA-??-500.. Series

INDE[®]

VNA Plot for IHPA-W1-500-40-10-N Attenuator (40dB/500W/10GHz)



Cross reference is based on manufacturers datasheets and is indicative only. Customers have to verify themselves exact specifications. We accept no legal liability whatsoever for use of this cross reference by the customer. While the information, contained herein in this datasheet, has been carefully compiled to the best of our knowledge, nothing is intended as representation or warranty on our part and no statement herein shall be construed as recommendation to infringe existing patents. We accept no liability of whatsoever for any fault and errors in this datasheet. Contents of this datasheet and specifications of the products are subject to change without notice due to continuous improvement.

N20